

OZTECH

Technical Brochure

Outdoor awnings, pergolas, curtain & blinds

2020



iZi 01

TERA 08

MUSE 17

HALO 24

HARBOUR 32



iZi

Outdoor awnings
pergolas, curtain & blinds



The IZI retractable system allows for a flexible solution for an existing timber or steel structure. The system offers a wind rating up to Beaufort class 11 (up to 117km/h) and is designed to stand up to even the worst of conditions rain, hail or shine.

The system is custom manufactured using high grade 6063 extruded aluminium profiles and is finished with thermoset powder coating which provides superior overall performance for exterior applications. All fixings are high grade stainless steel to ensure extended life.

Single Module

Width. **2m > 5m**

Single module with
single motor & 2 rafters

Projection. **Max.10m**

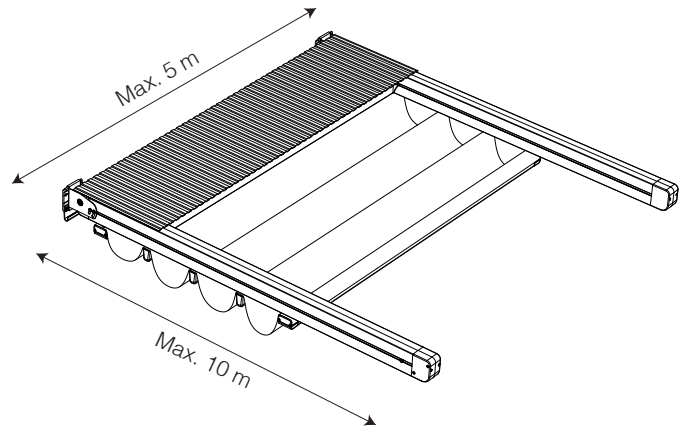

Double Module

Width. **5m > 9m**

Double modules with
single motor & 3 rafters

Projection. **Max.10m**

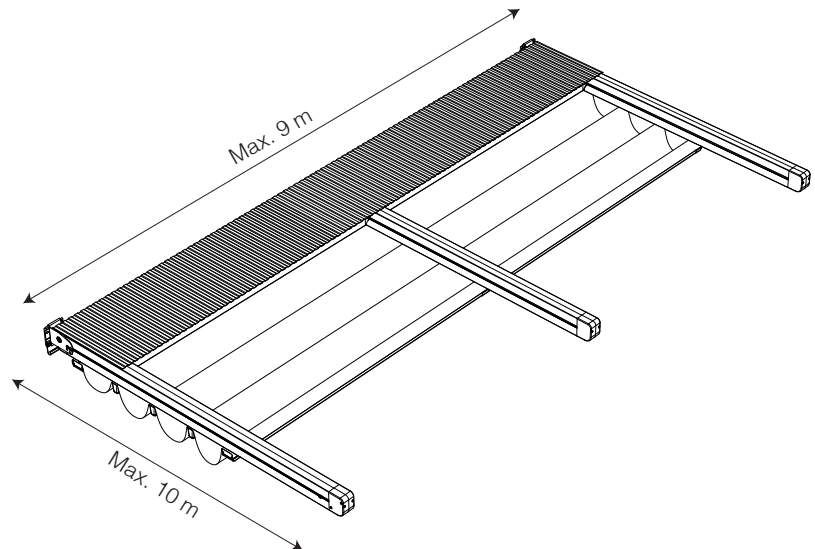

Triple Module

Width. **9m > 13m**

Triple modules with
single motor & 4 rafters

Projection. **Max.10m**

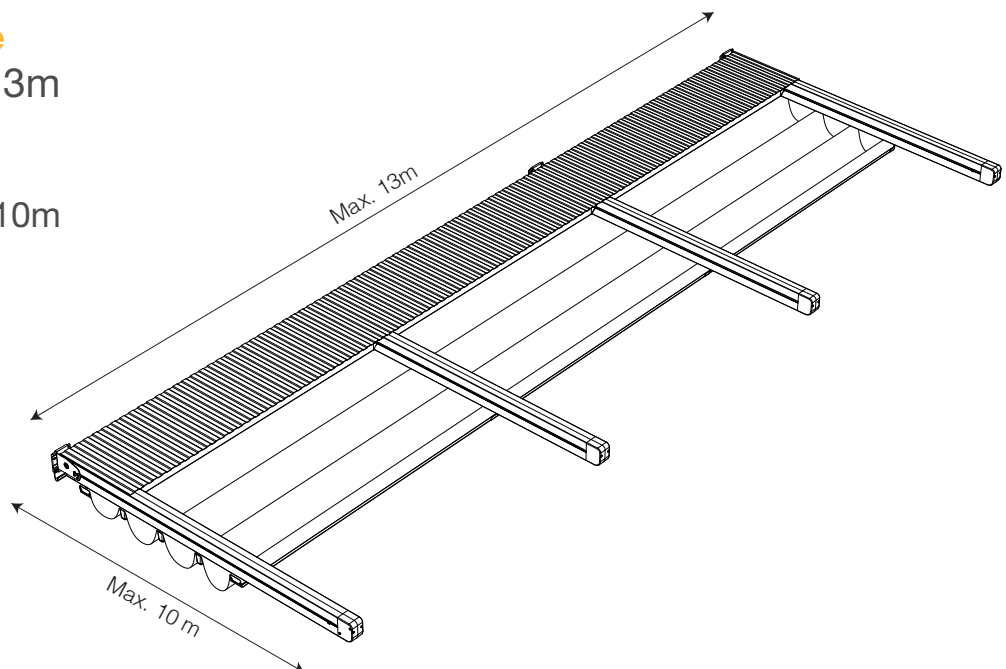



► PROFILE DETAILS

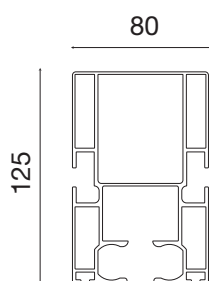

① Rafter

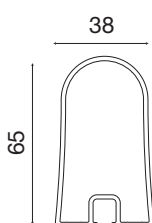

② Fabric Support

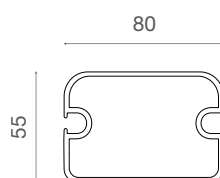

③ Puller Profile

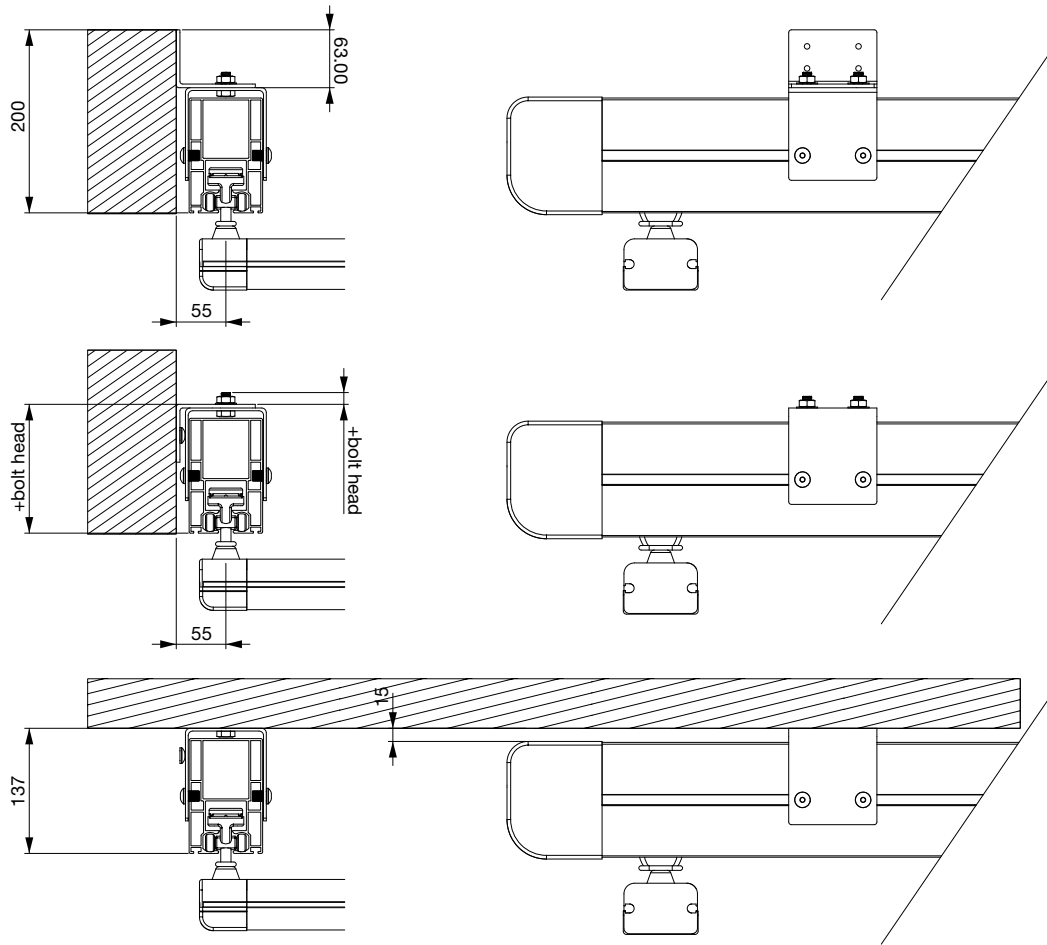

Hang bracket L type

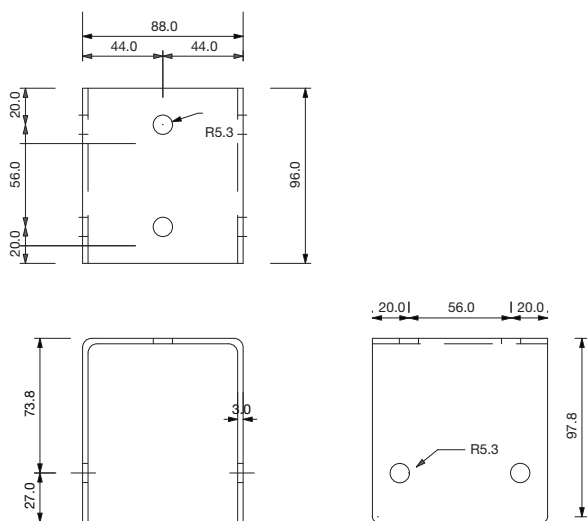

Hang bracket U type

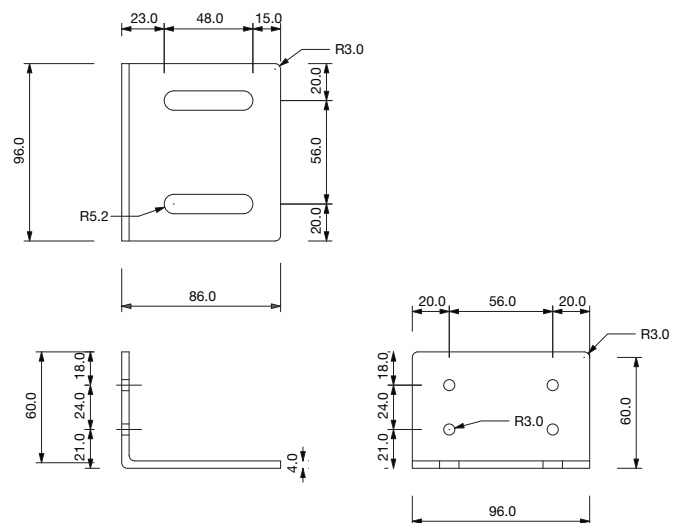

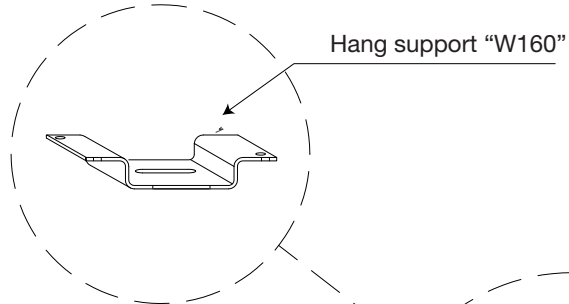
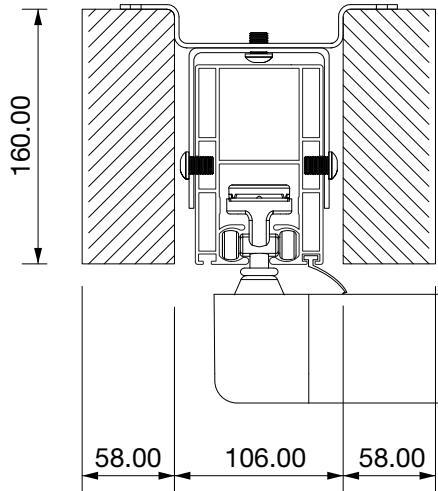

Hang support "W160"

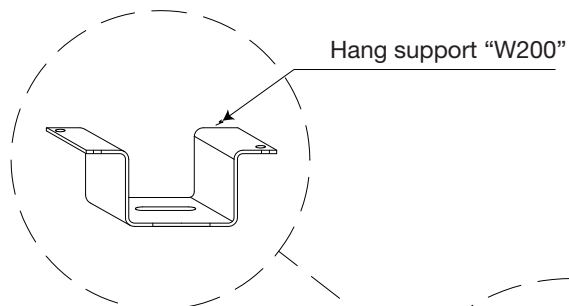
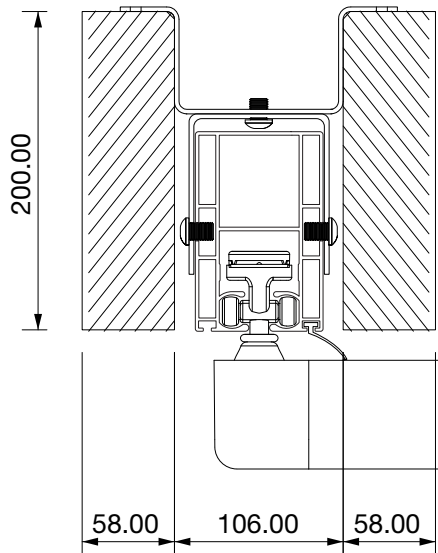
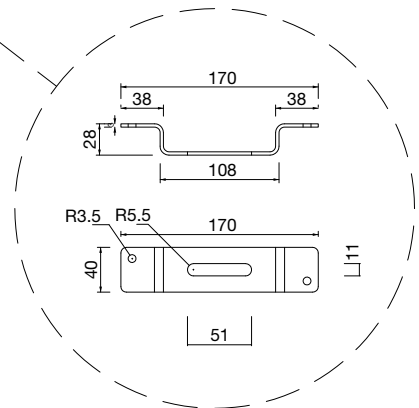

Hang support "W200"

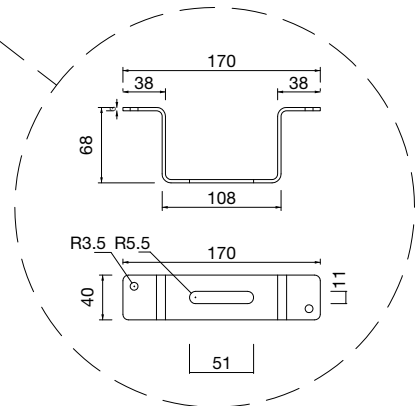

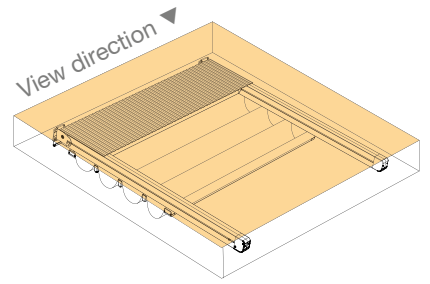

A. Width

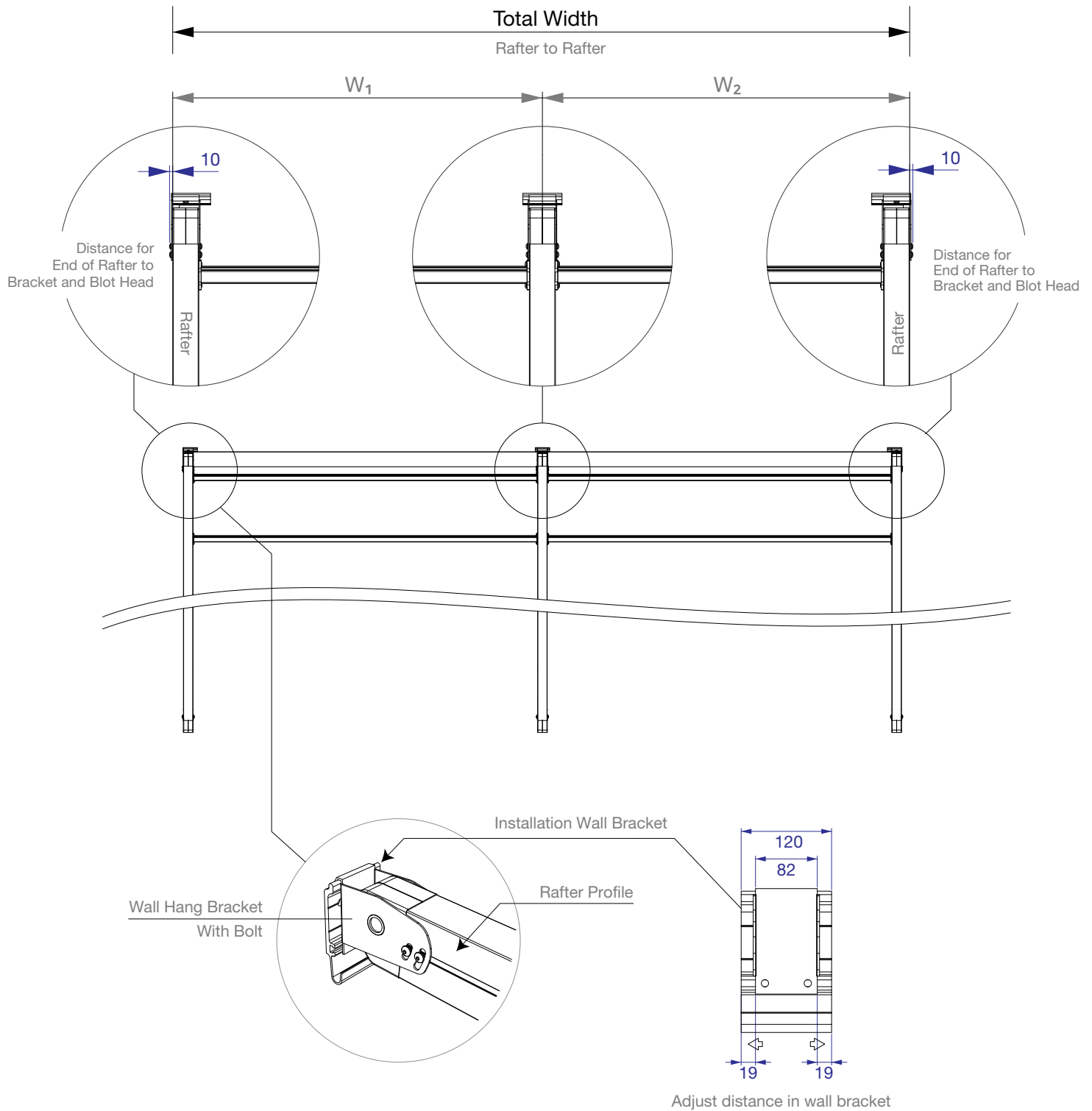

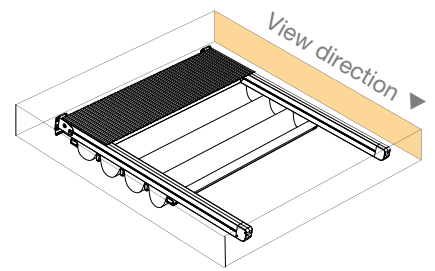

B. Projection

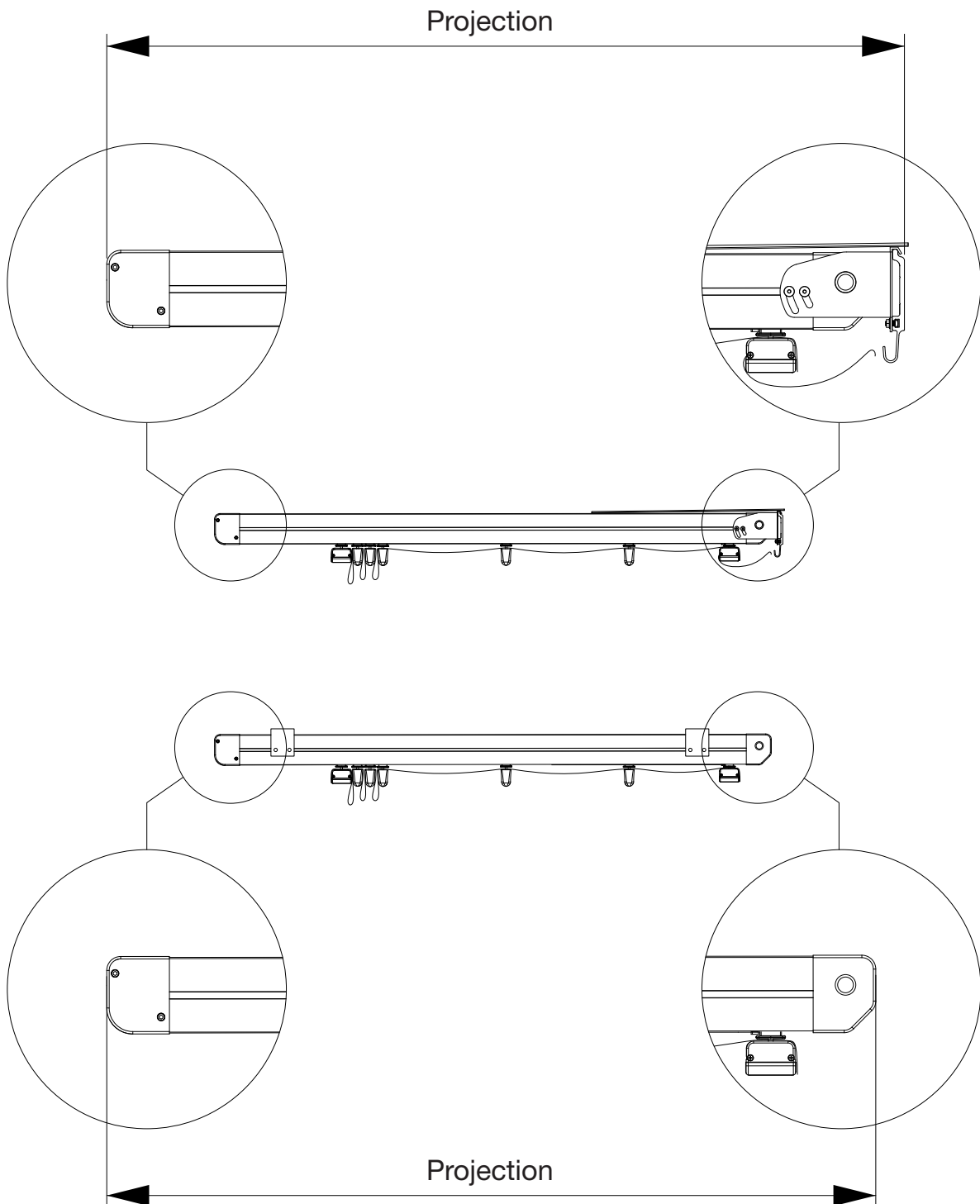



TERA

Outdoor awnings
pergolas, curtain & blinds



The TERA retractable system provides the user with a designer cover that allows the outdoor area to be used all year round. The system offers a wind rating up to 117km/h and offers protection from the elements.

The system is custom manufactured using high grade 6063 extruded aluminium profiles and is finished with thermoset powder coating which provides superior overall performance for exterior applications. All fixings are high grade stainless steel to ensure extended life.

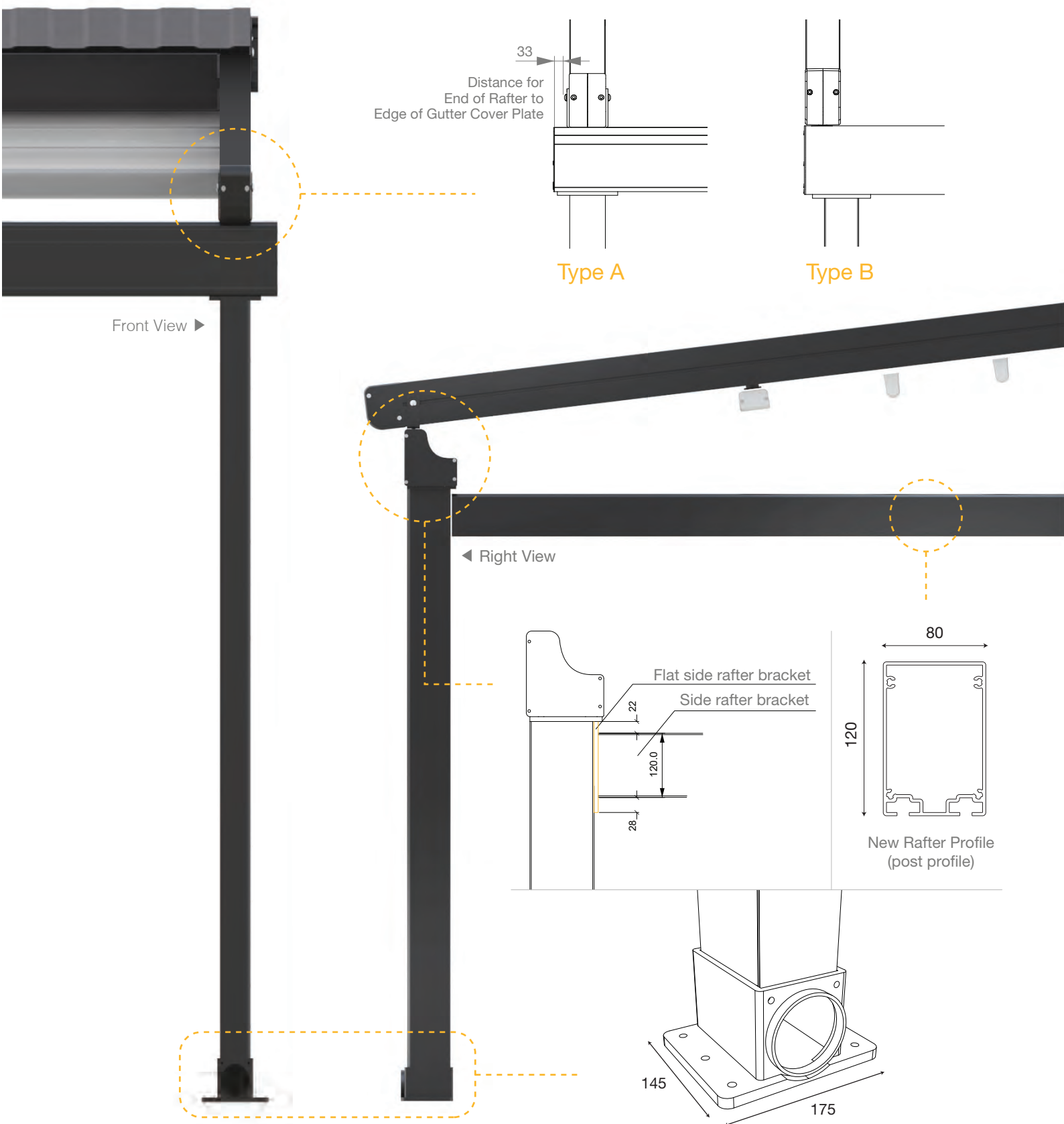

Single Module

Width. **2m > 5m**

Single module with
single motor & 2 rafters

Projection. **Max.10m**

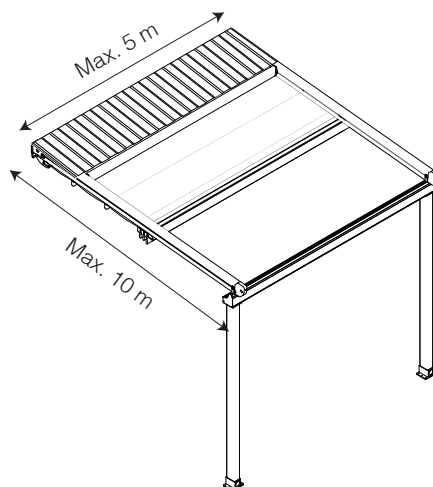

Double Module

Width. **5m > 9m**

Double modules with
single motor & 3 rafters

Projection. **Max.10m**

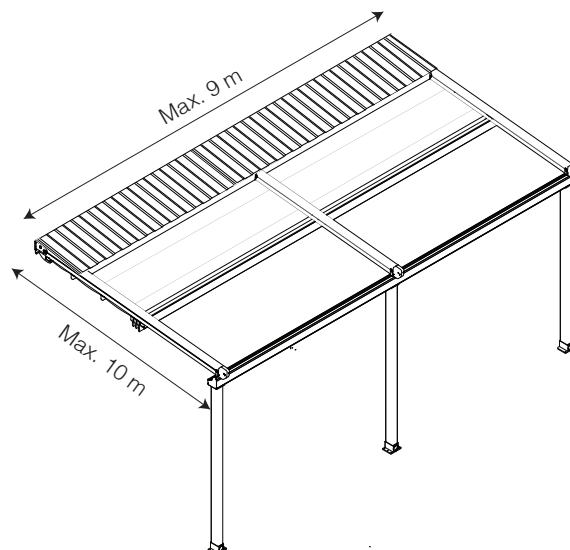

Triple Module

Width. **9m > 13m**

Triple modules with
single motor & 4 rafters

Projection. **Max.10m**

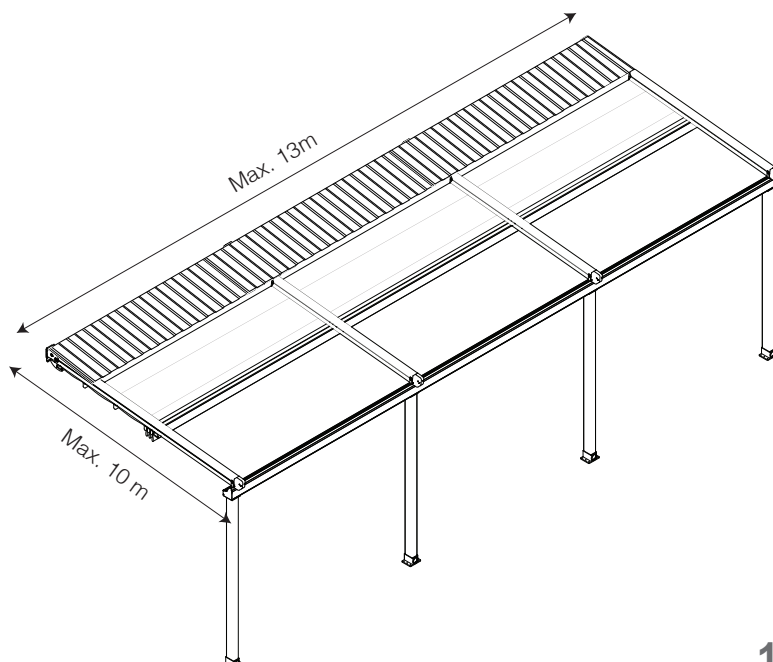



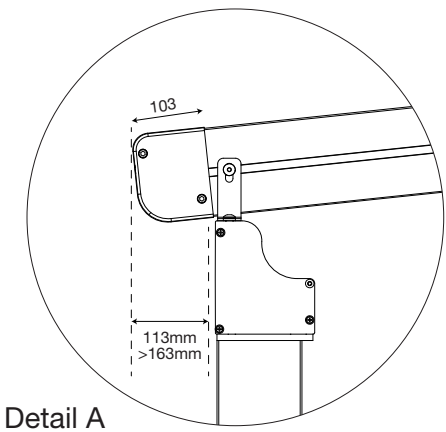
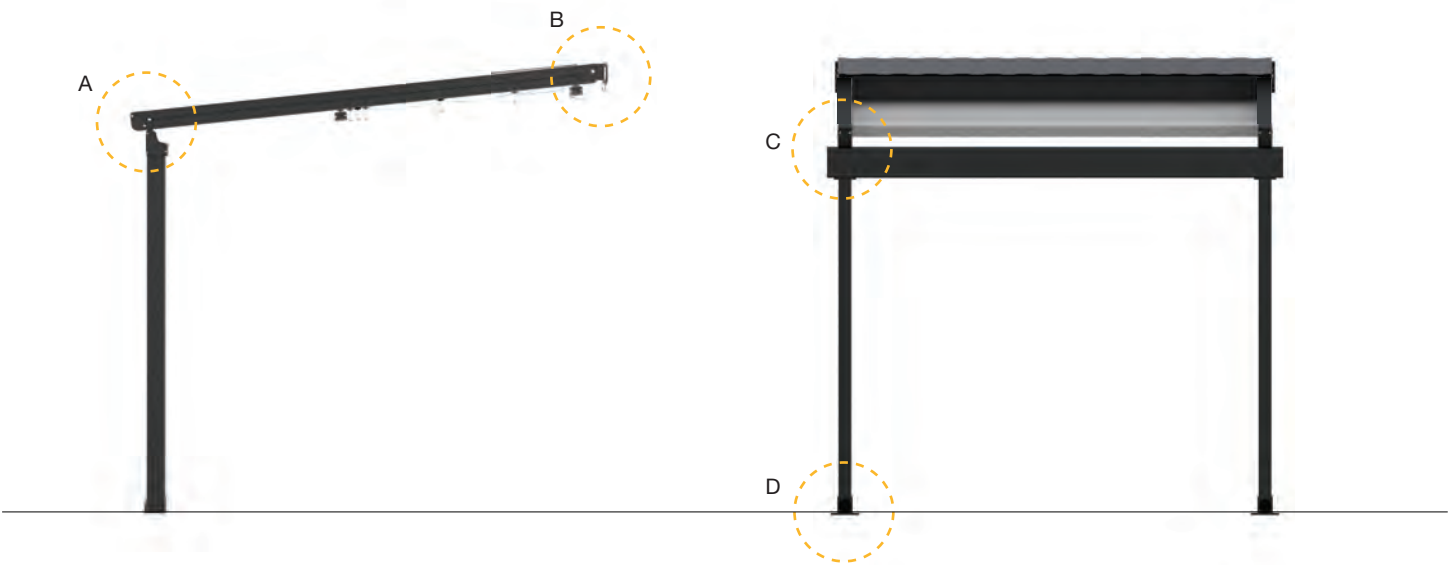

Detail A

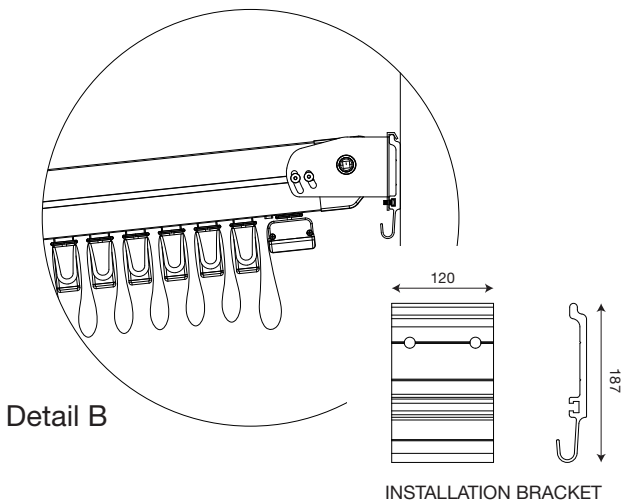

Detail B

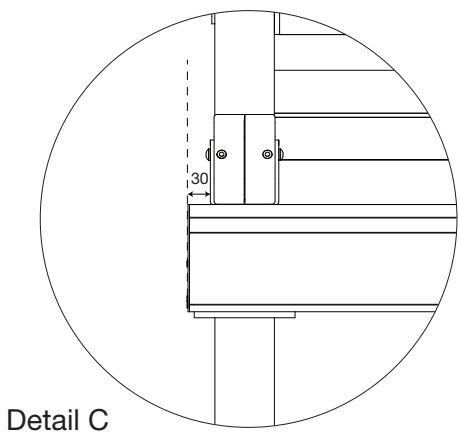

Detail C

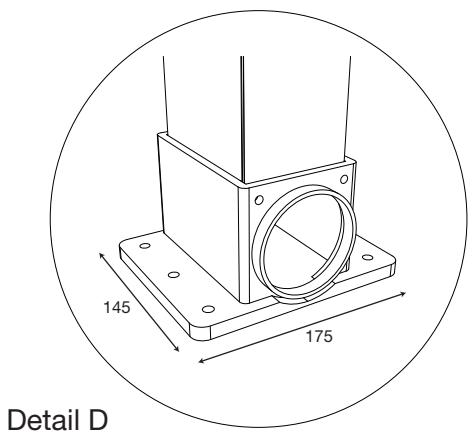

Detail D

A. Width

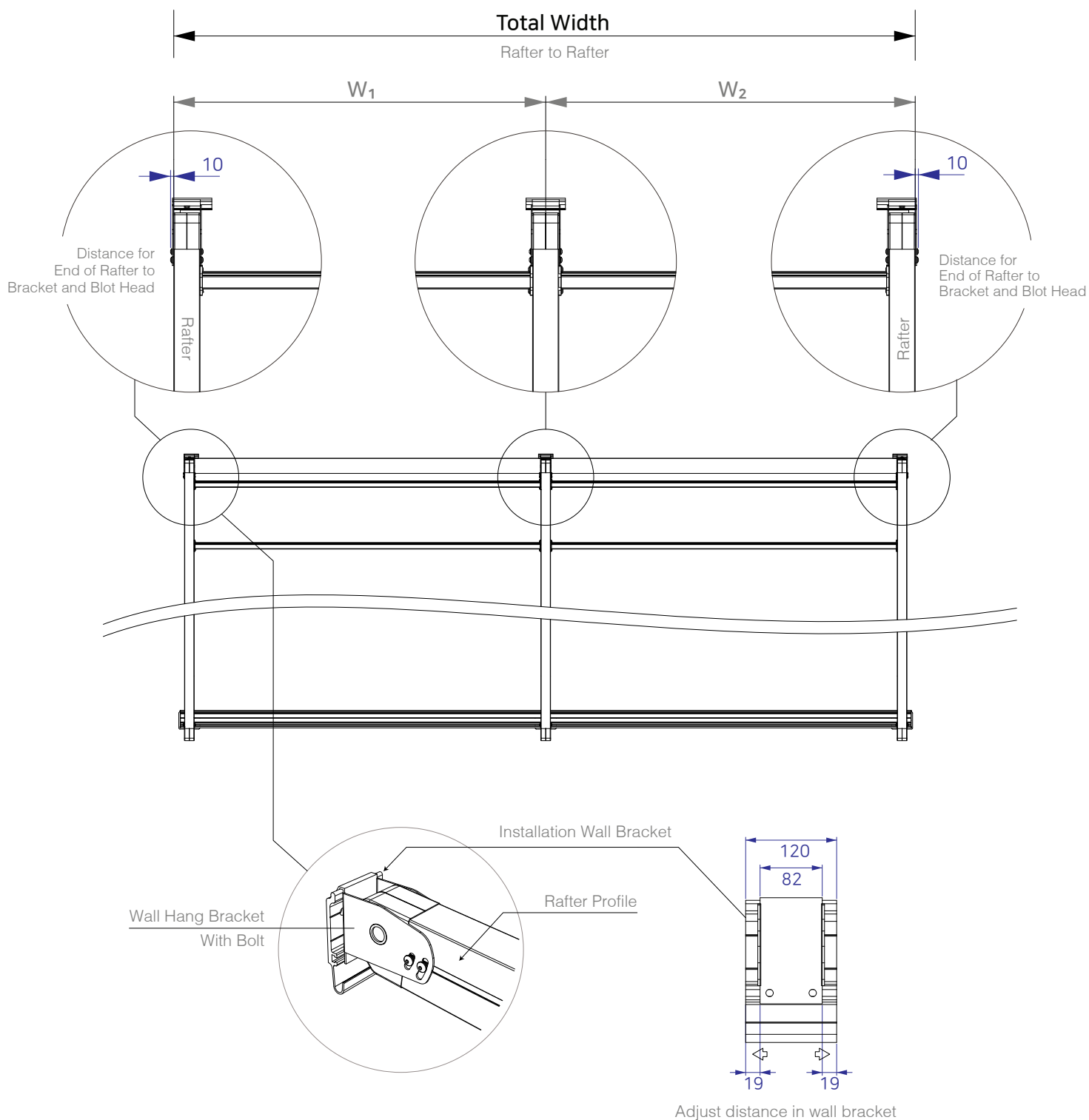
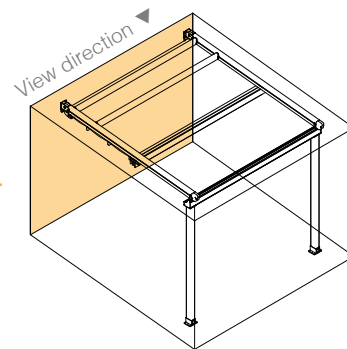

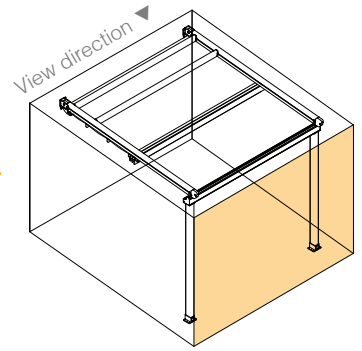

A. Width

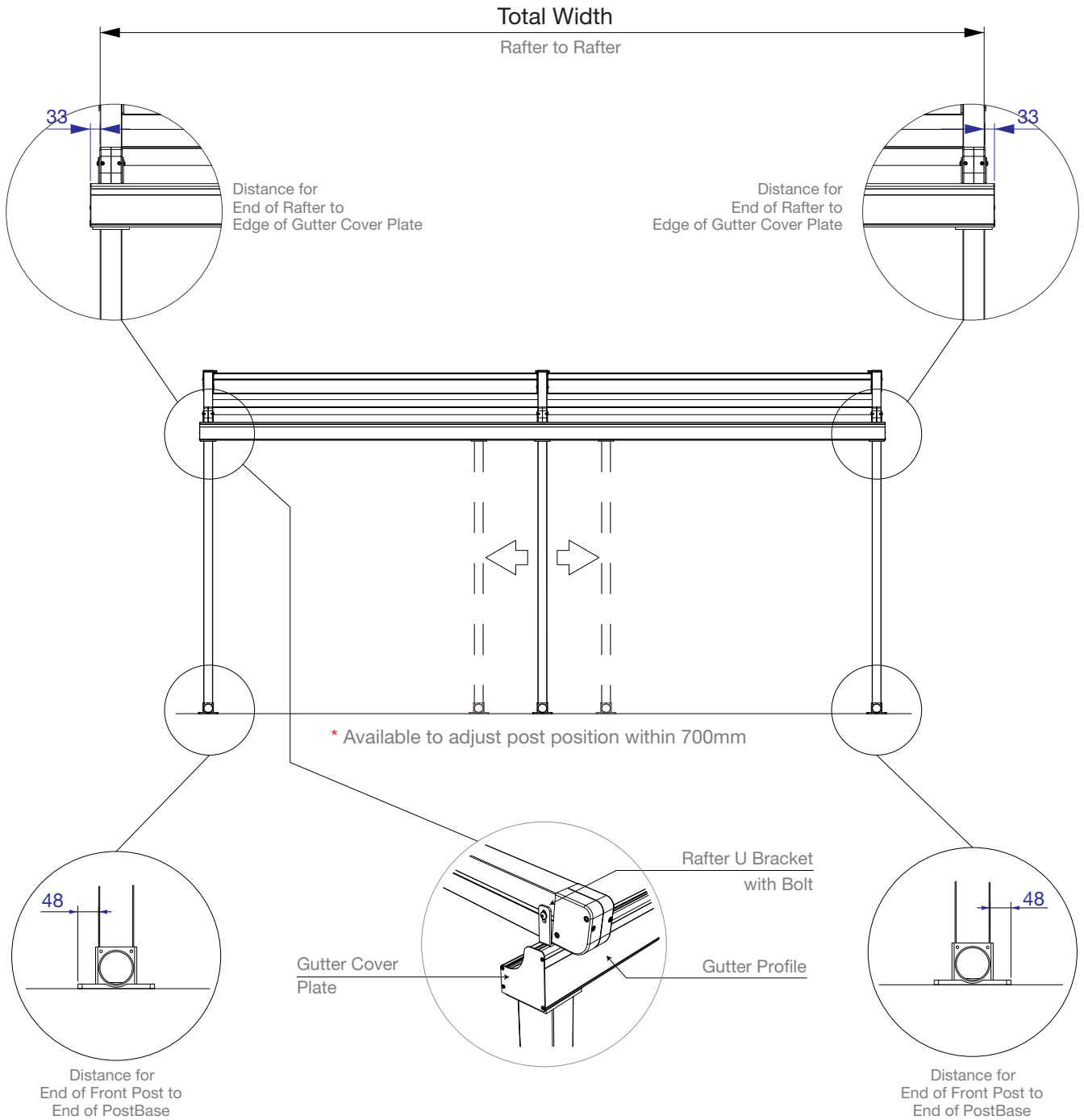

B. Projection & Height

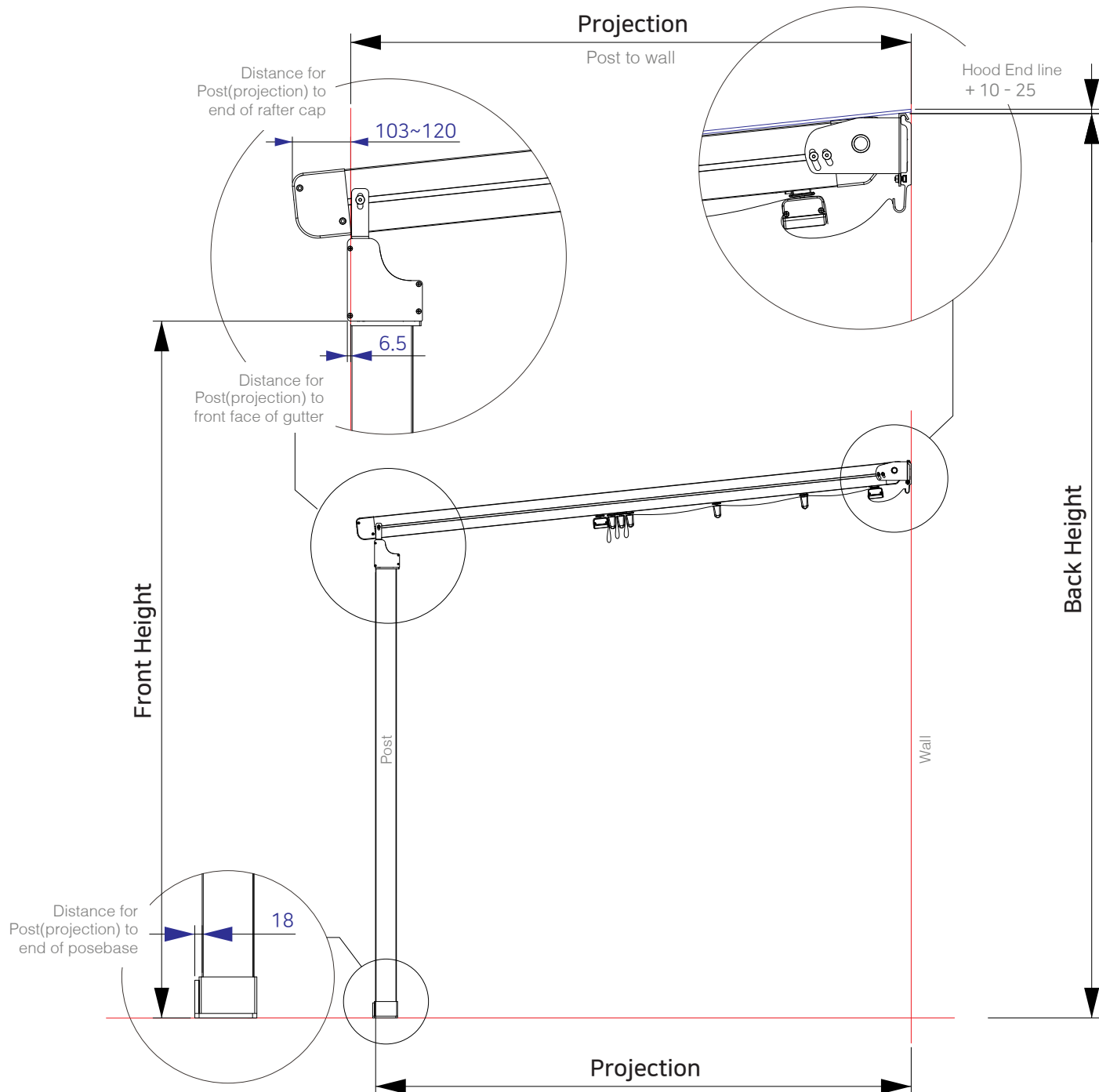
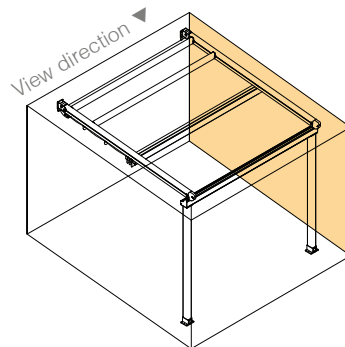

C. Angle

TERA	2.0 M	fall	2.5 M	fall	3.0 M	fall	3.5 M	fall	4.0 M	fall	4.5 M	fall	5.0 M	fall
2.0 M	2.7 °	379	3.5 °	407	4.5 °	442	5.0 °	460	5.7 °	485	6.0 °	495	7.0 °	531
3.0 M	2.7 °	426	3.5 °	468	4.5 °	521	5.0 °	547	5.7 °	584	6.0 °	600	7.0 °	653
4.0 M	2.7 °	474	3.5 °	530	4.5 °	600	5.0 °	635	5.7 °	684	6.0 °	705	7.0 °	776
5.0 M	3.4 °	585	4.5 °	679	5.5 °	766	6.0 °	811	6.0 °	811	6.5 °	855	7.5 °	943
6.0 M	3.4 °	645	4.5 °	757	5.5 °	863	6.0 °	916	6.0 °	916	7.5 °	1075	8.5 °	1182
7.0 M	3.4 °	705	4.5 °	836	5.5 °	959	6.0 °	1021	7.0 °	1144	7.5 °	1207	8.5 °	1331
8.0 M	4.5 °	915	5.5 °	1055	6.5 °	1196	7.0 °	1267	7.0 °	1267	9.0 °	1552	10.0 °	1696
9.0 M	4.5 °	993	5.5 °	1152	6.5 °	1310	7.0 °	1390	8.0 °	1550	9.0 °	1710	10.0 °	1872
10.0 M	4.5 °	1072	5.5 °	1248	6.5 °	1424	7.0 °	1513	8.0 °	1690	9.0 °	1869	10.0 °	2048

If lesser pitch than above table is required, please contact our staff for more details.



MUSE

Outdoor awnings
pergolas, curtain & blinds



The MUSE retractable system provides an elegant outdoor shade system which can be integrated with a timber finish to give it a natural look.

The system is custom manufactured using high grade 6063 extruded aluminium profiles and is finished with thermoset powder coating which provides superior overall performance for exterior applications. All fixings are high grade stainless steel to ensure extended life.

Single Module

Width. **2m > 5m**

Single module with
single motor & 2 rafters

Projection. **Max.5m**

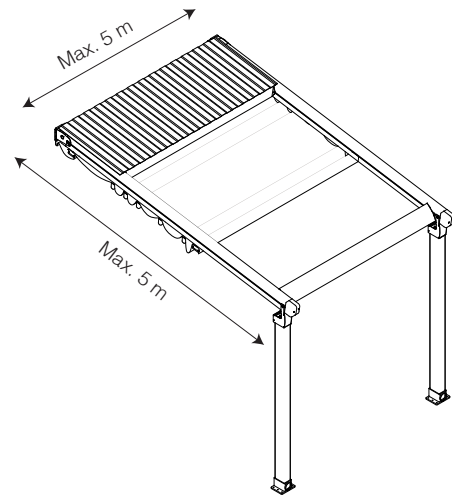

Double Module

Width. **5m > 9m**

Double modules with
single motor & 3 rafters

Projection. **Max.5m**

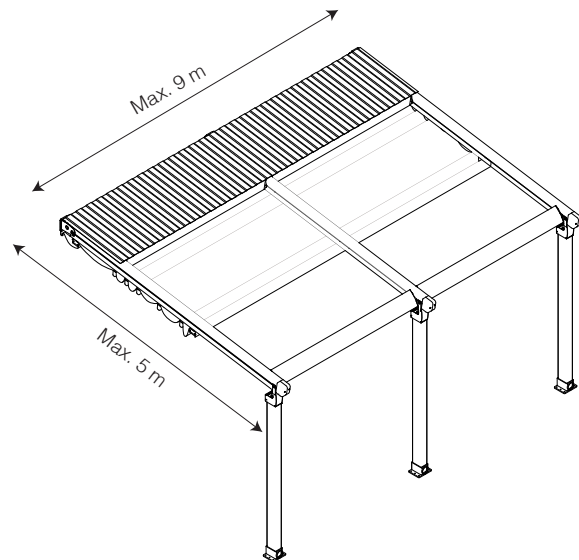

Triple Module

Width. **9m > 13m**

Triple modules with
single motor & 4 rafters

Projection. **Max.5m**

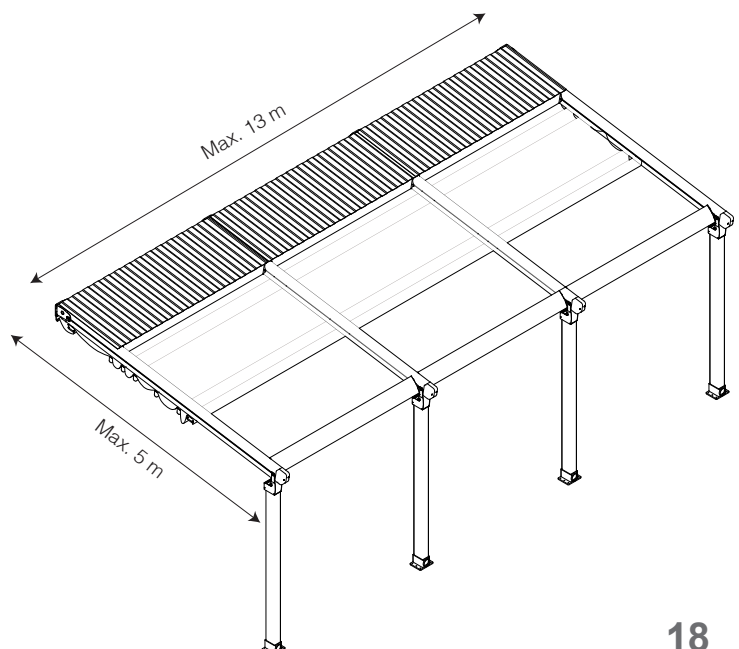



► PROFILE DETAILS

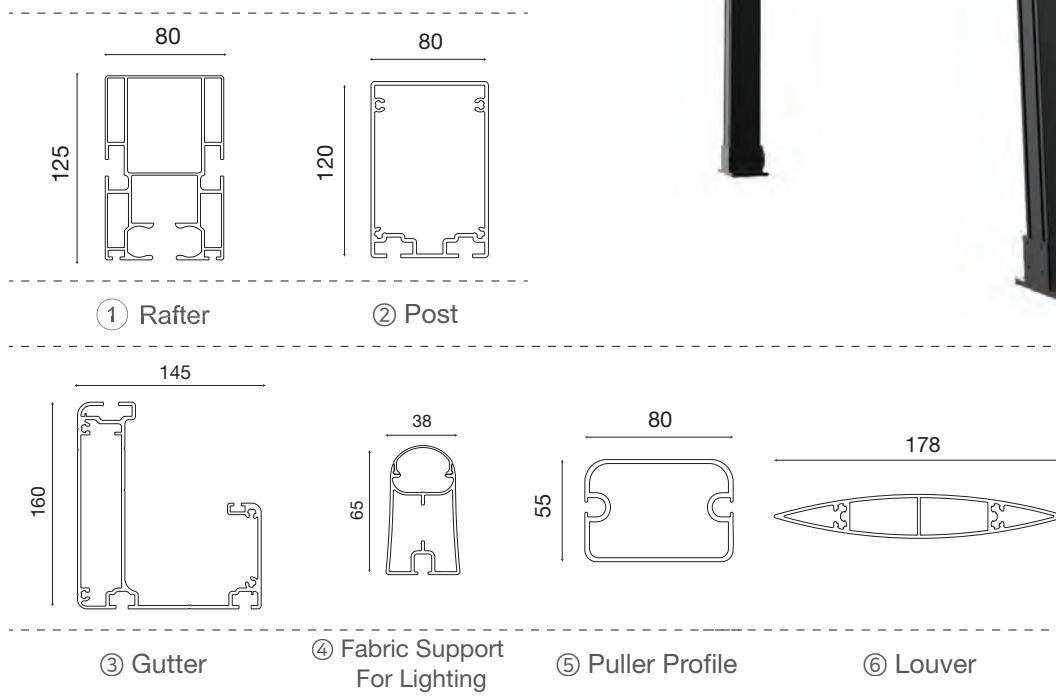

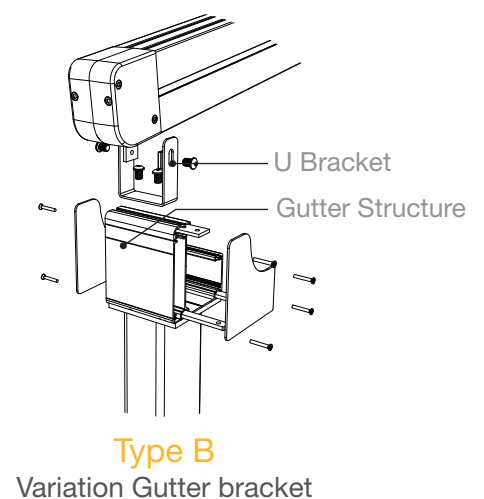
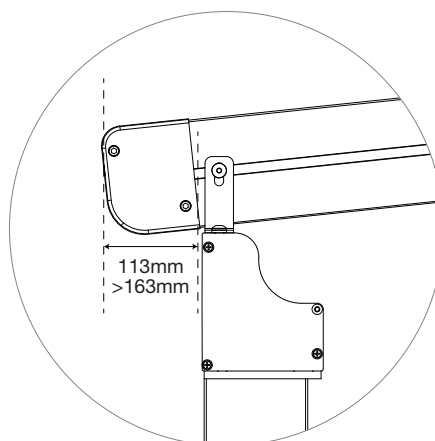
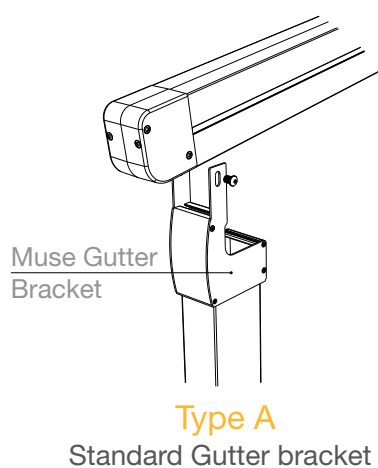
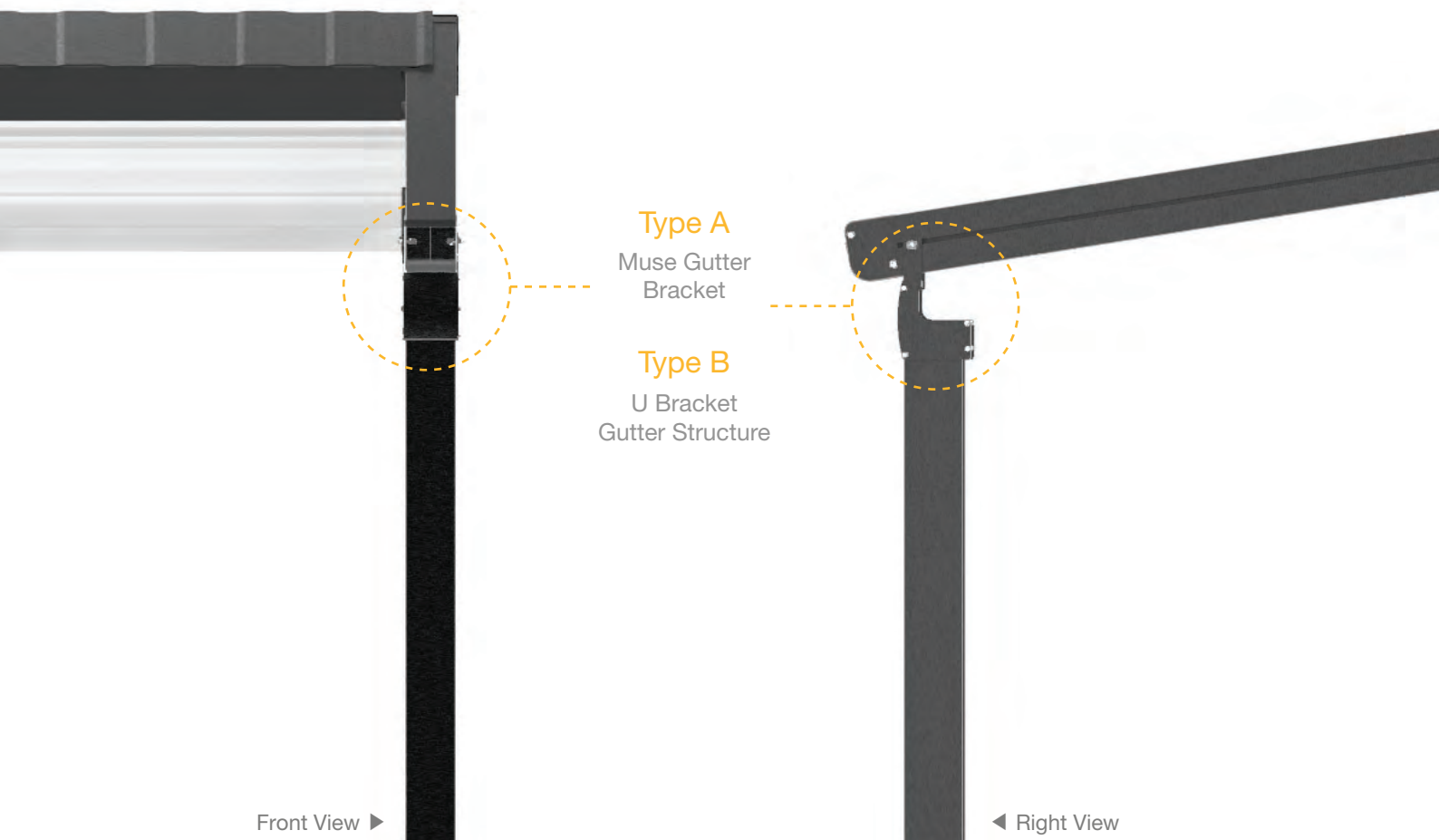

A. Width

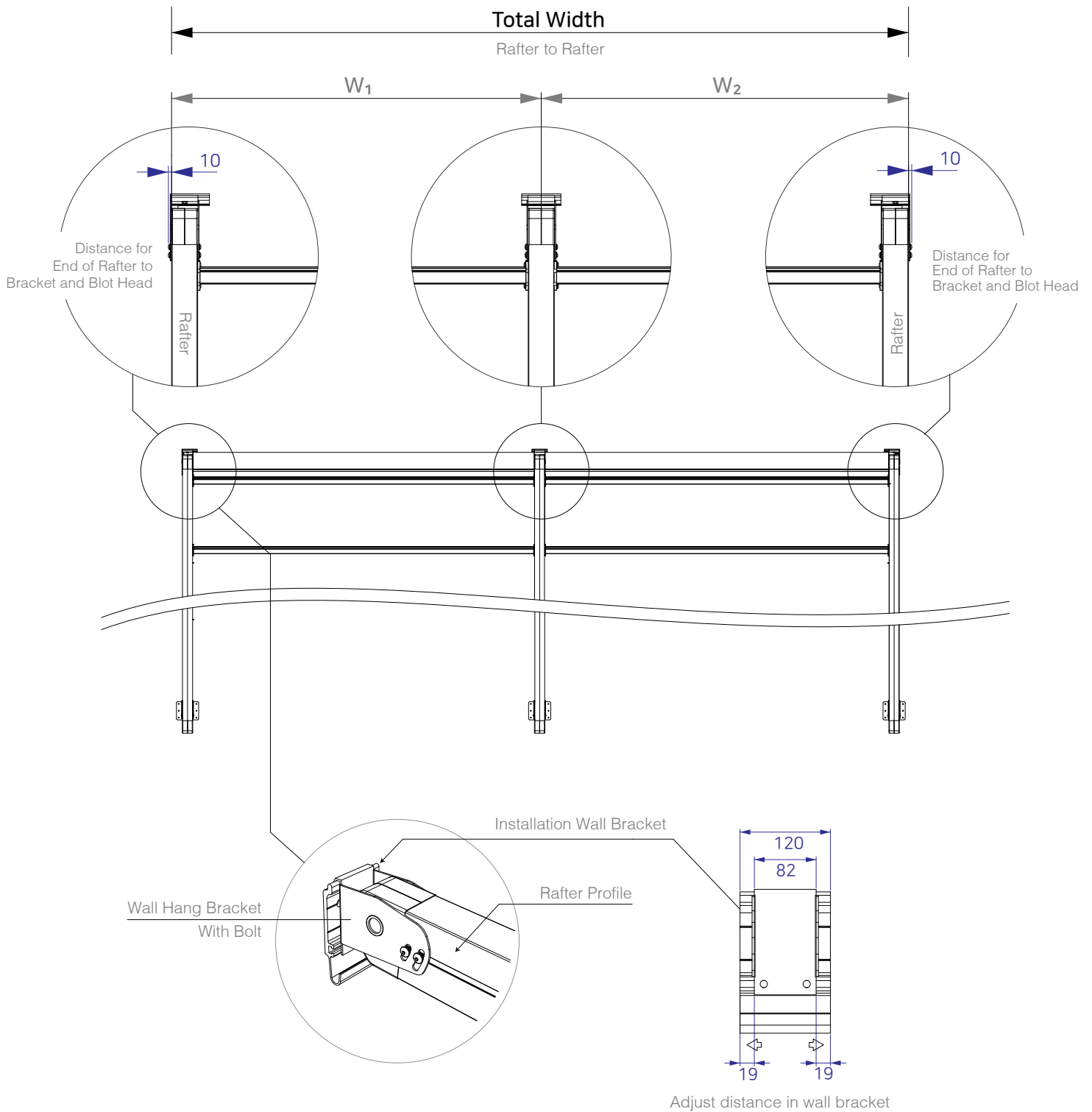
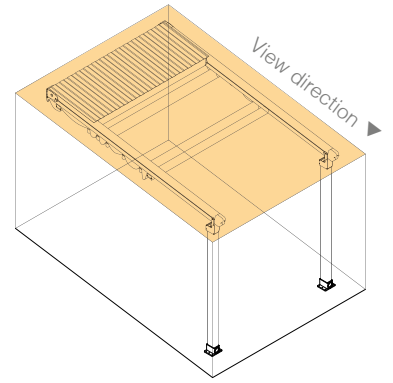

MUSE

A. Width

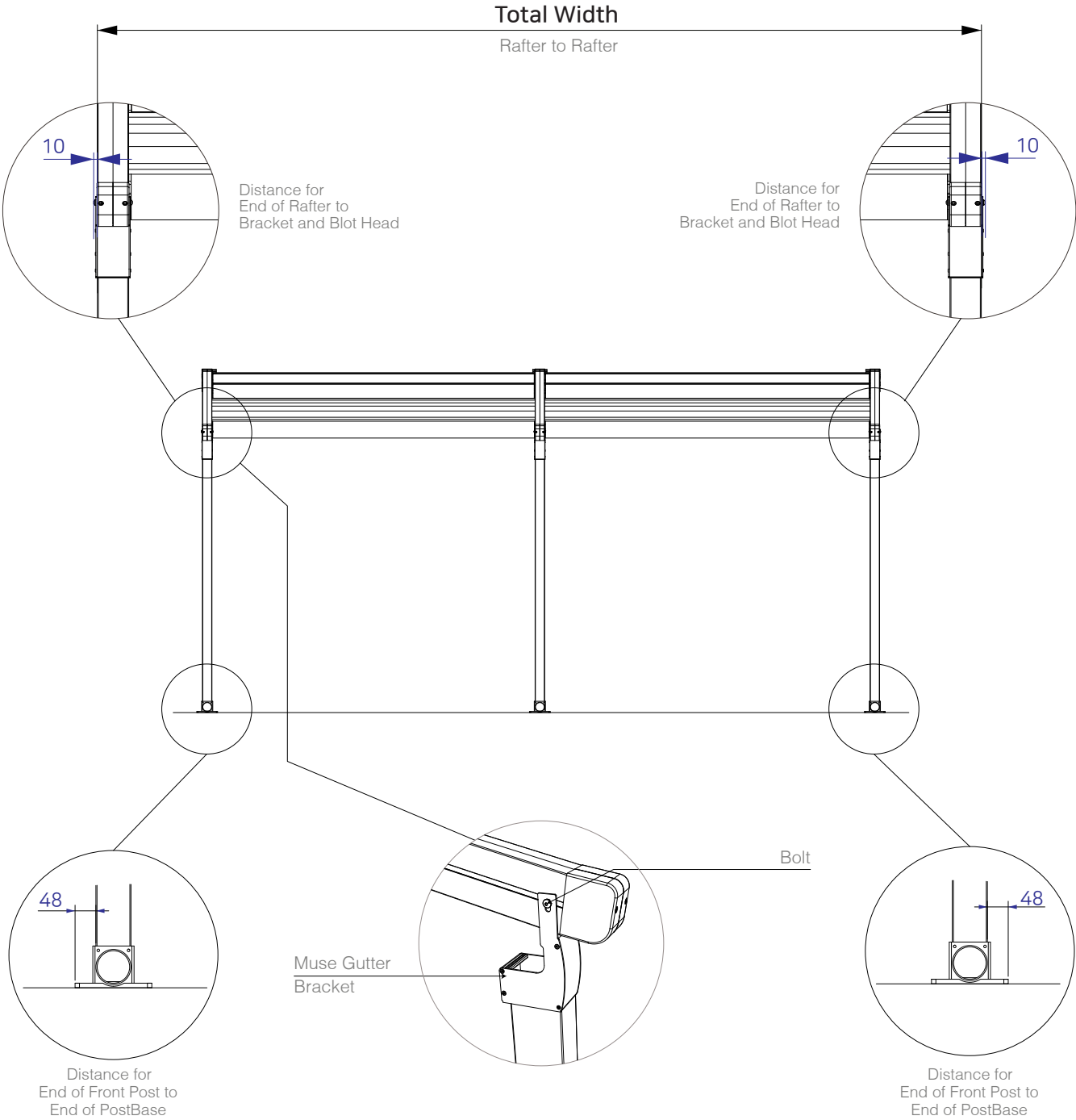
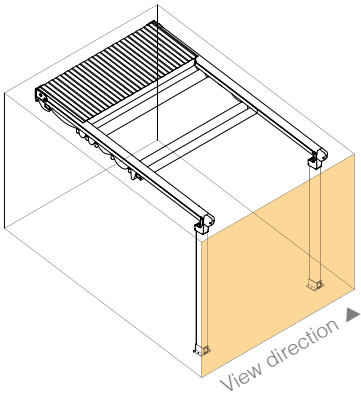

B. Projection & Height

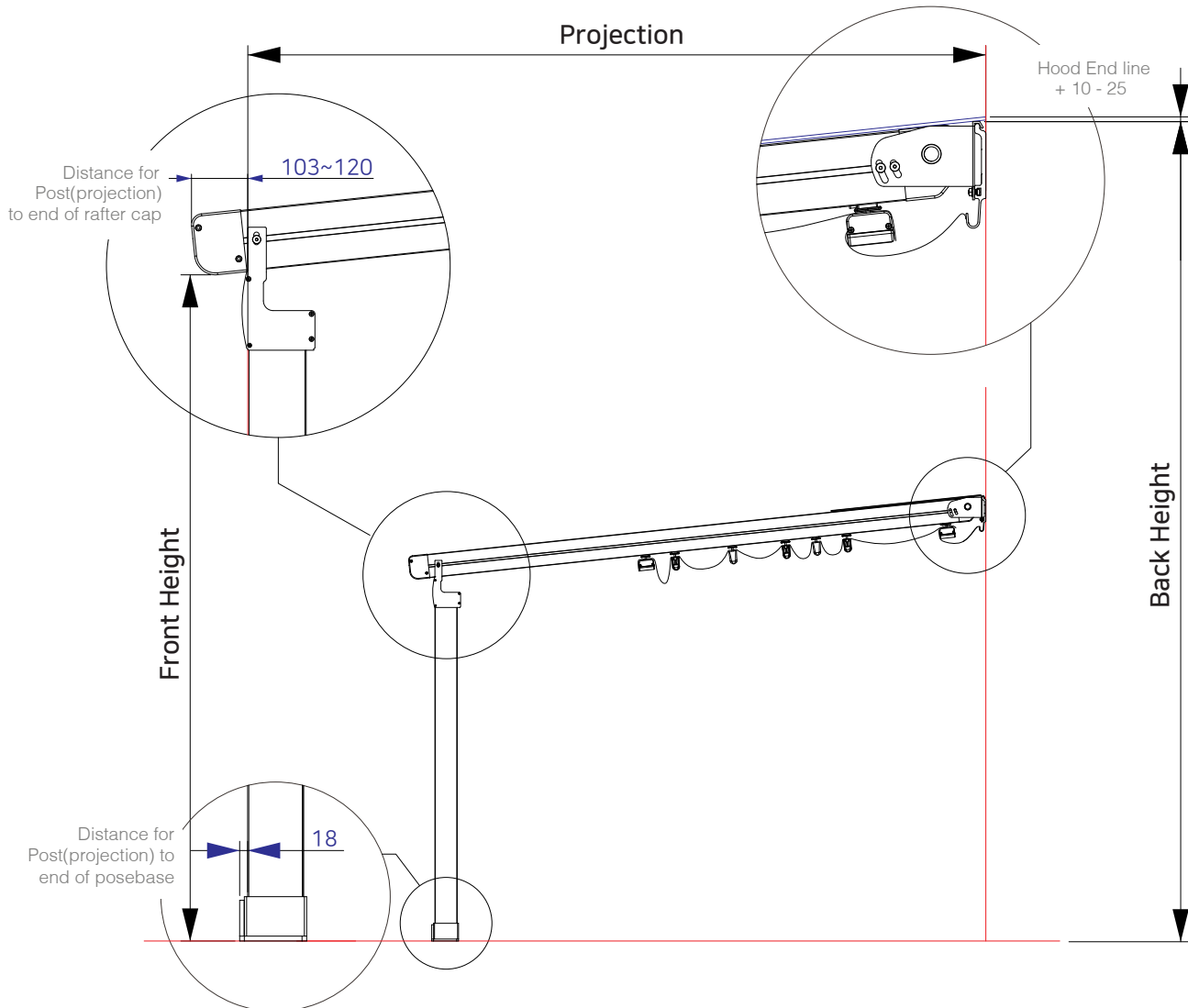
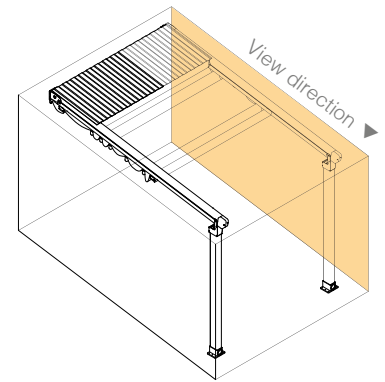

C. Angle

MUSE	2.0 M	fall	2.5 M	fall	3.0 M	fall	3.5 M	fall	4.0 M	fall	4.5 M	fall	5.0 M	fall
2.0 M	2.7 °	229	3.5 °	257	4.5 °	292	5.0 °	310	5.7 °	335	6.0 °	345	7.0 °	381
3.0 M	2.7 °	276	3.5 °	318	4.5 °	371	5.0 °	397	5.7 °	434	6.0 °	450	7.0 °	503
4.0 M	2.7 °	324	3.5 °	380	4.5 °	450	5.0 °	485	5.7 °	534	6.0 °	555	7.0 °	626
5.0 M	3.4 °	435	4.5 °	529	5.5 °	616	6.0 °	661	6.0 °	661	6.5 °	705	7.5 °	793

If lesser pitch than above table is required, please contact our staff for more details.



HALO

Outdoor awnings
pergolas, curtain & blinds



The Halo retractable system provides a stylish architectural covering which allows large outdoor areas to be used under all weather conditions.

The system is custom manufactured using high grade 6063 extruded aluminium profiles and is finished with thermoset powder coating which provides superior overall performance for exterior applications. All fixings are high grade stainless steel to ensure extended life.

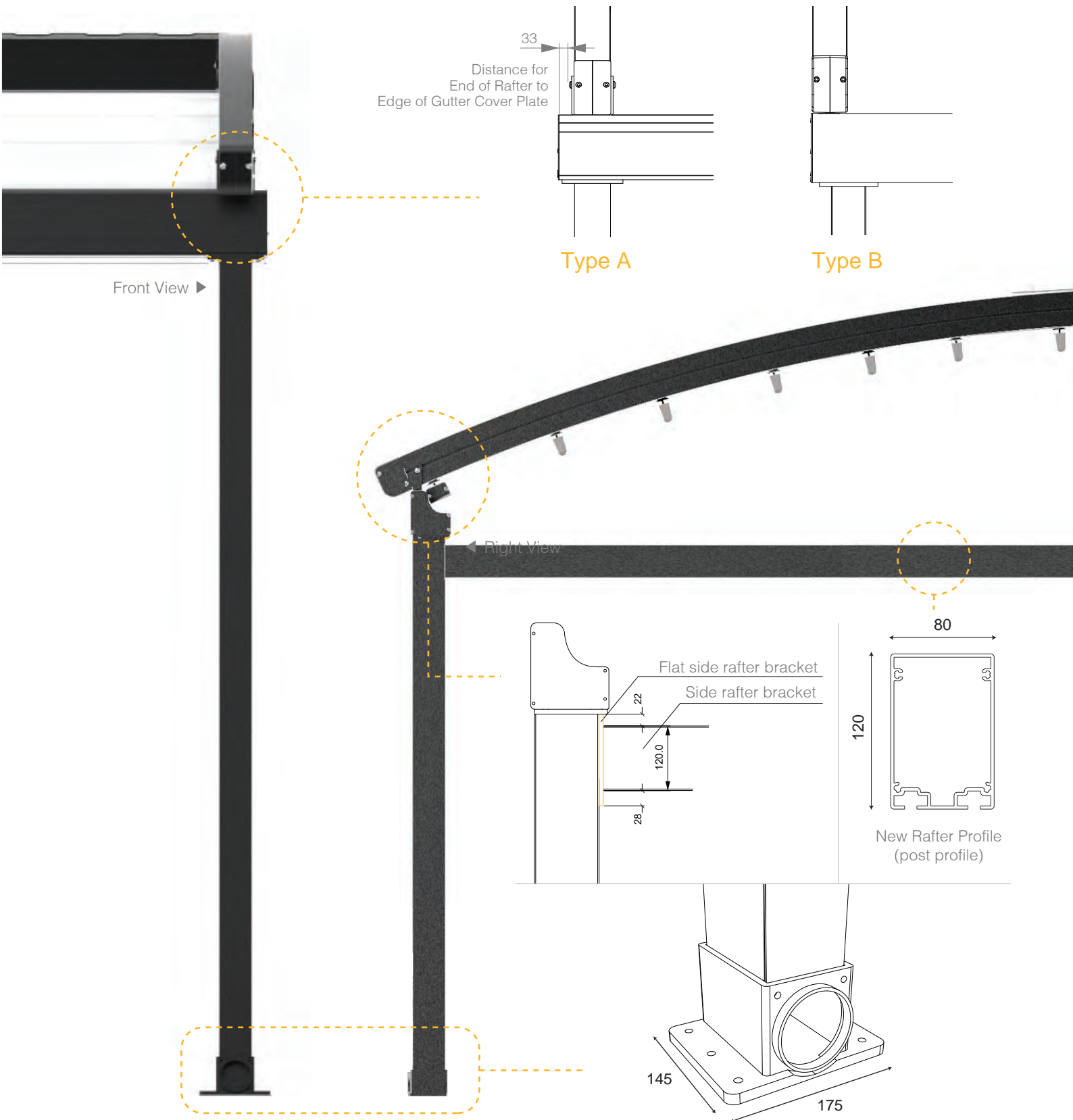

Single Module

Width. **2m > 5m**

Single module with
single motor & 2 rafters

Projection. **Max.10m**

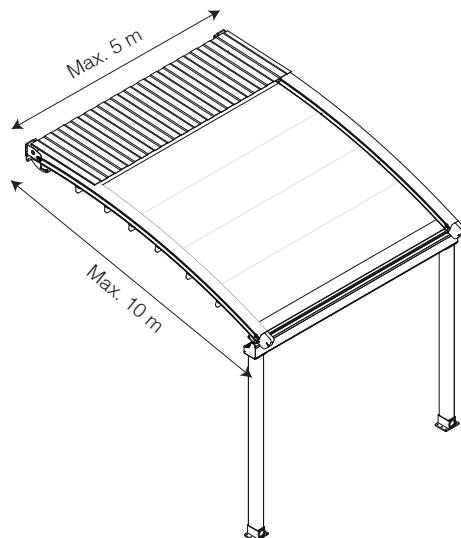

Double Module

Width. **5m > 9m**

Double modules with
single motor & 3 rafters

Projection. **Max.10m**

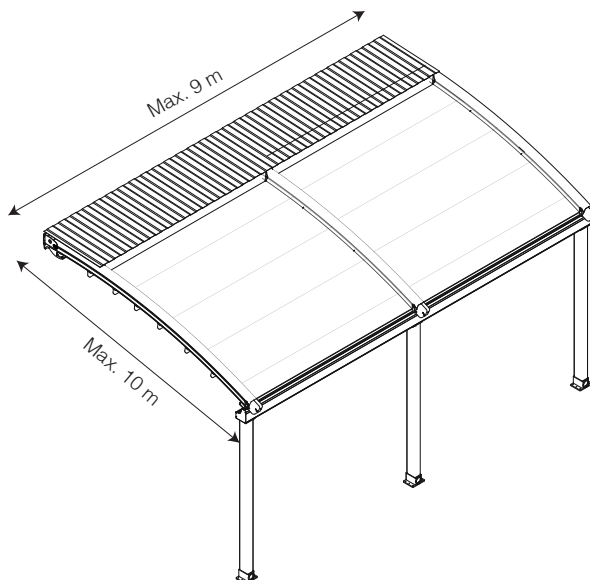

Triple Module

Width. **9m > 13m**

Triple modules with
single motor & 4 rafters

Projection. **Max.10m**

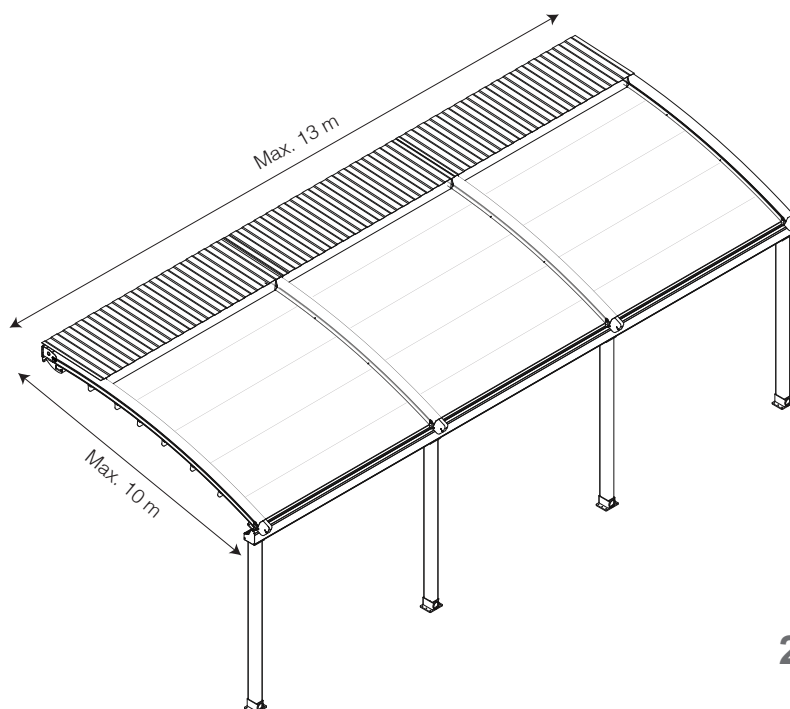



► PROFILE DETAILS

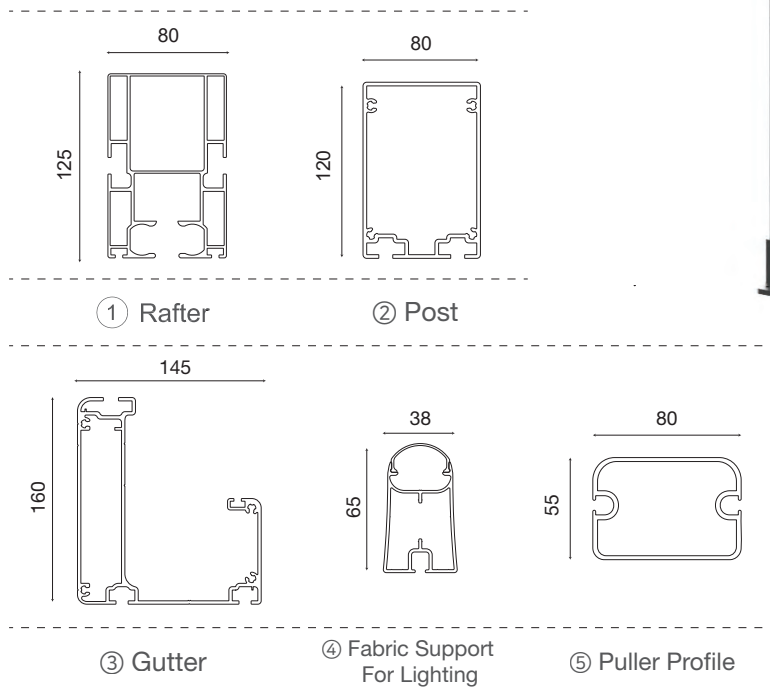

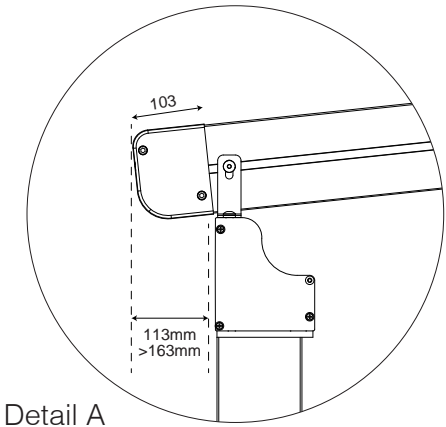
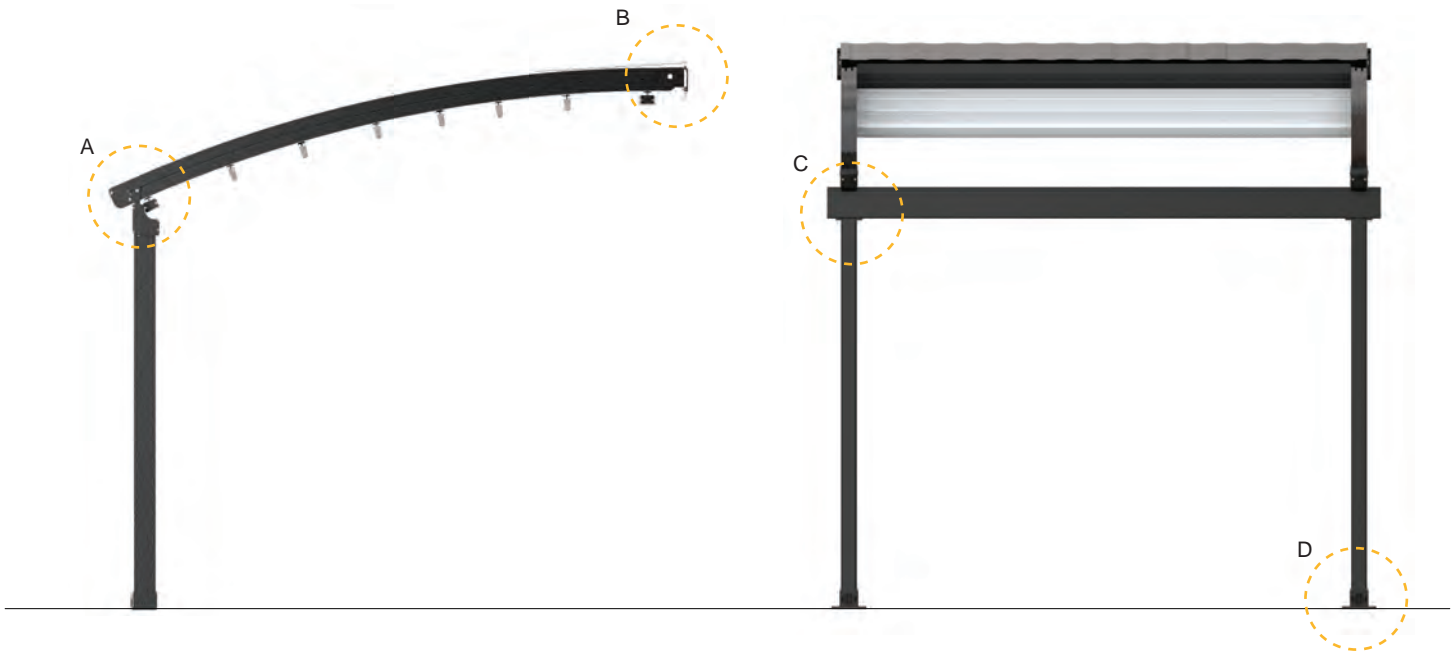

Detail A

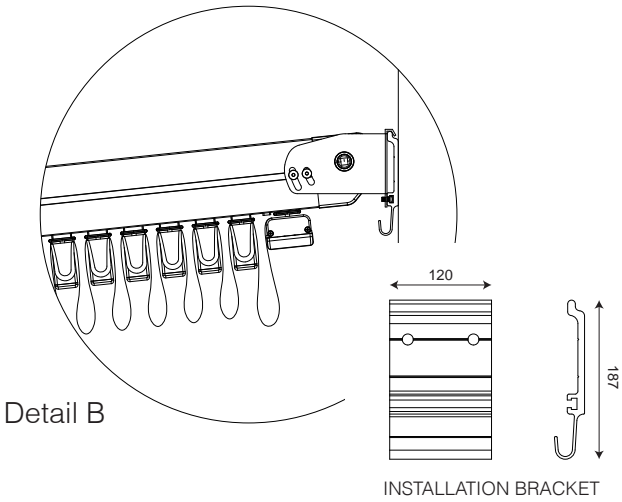

Detail B

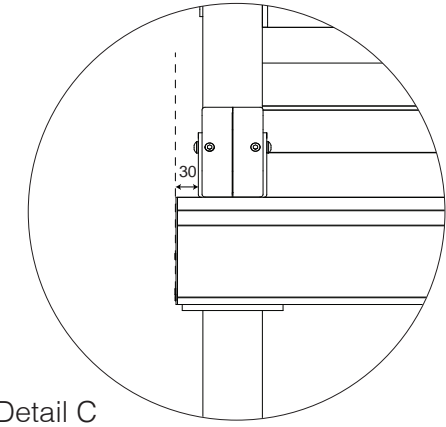

Detail C

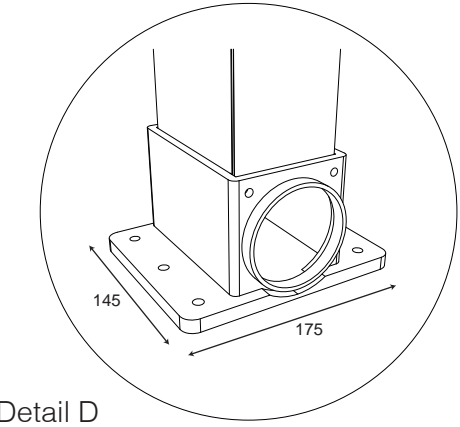

Detail D

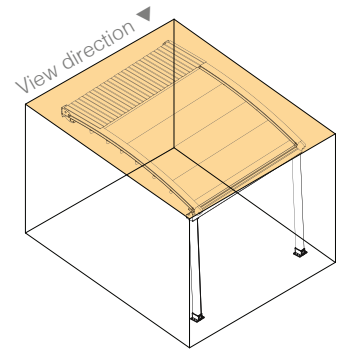

A. Width

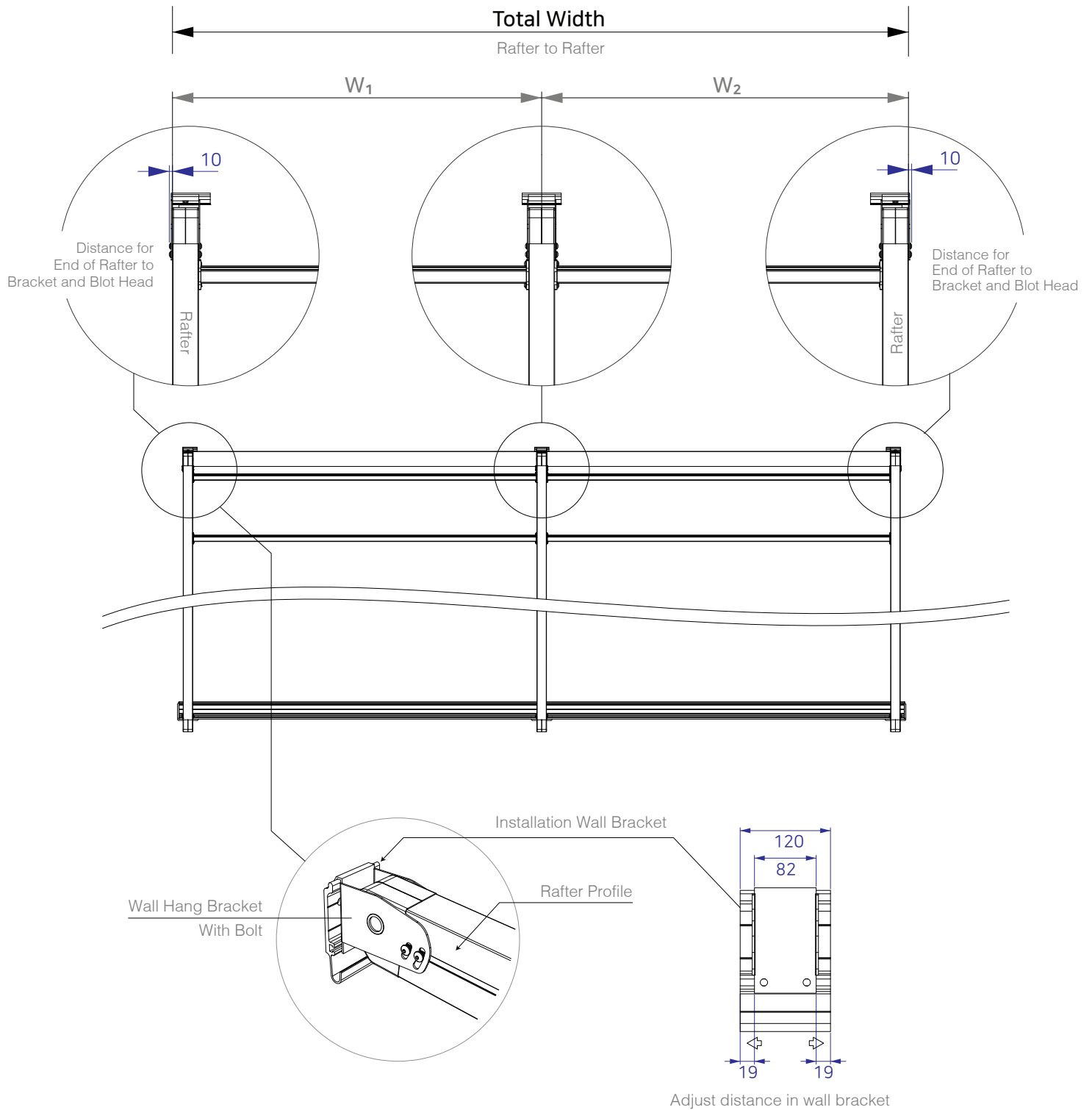

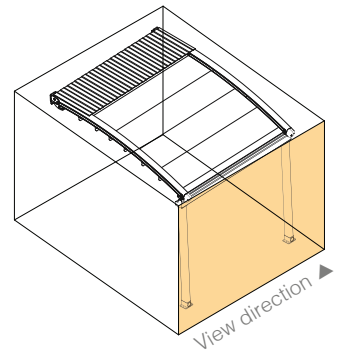

A. Width

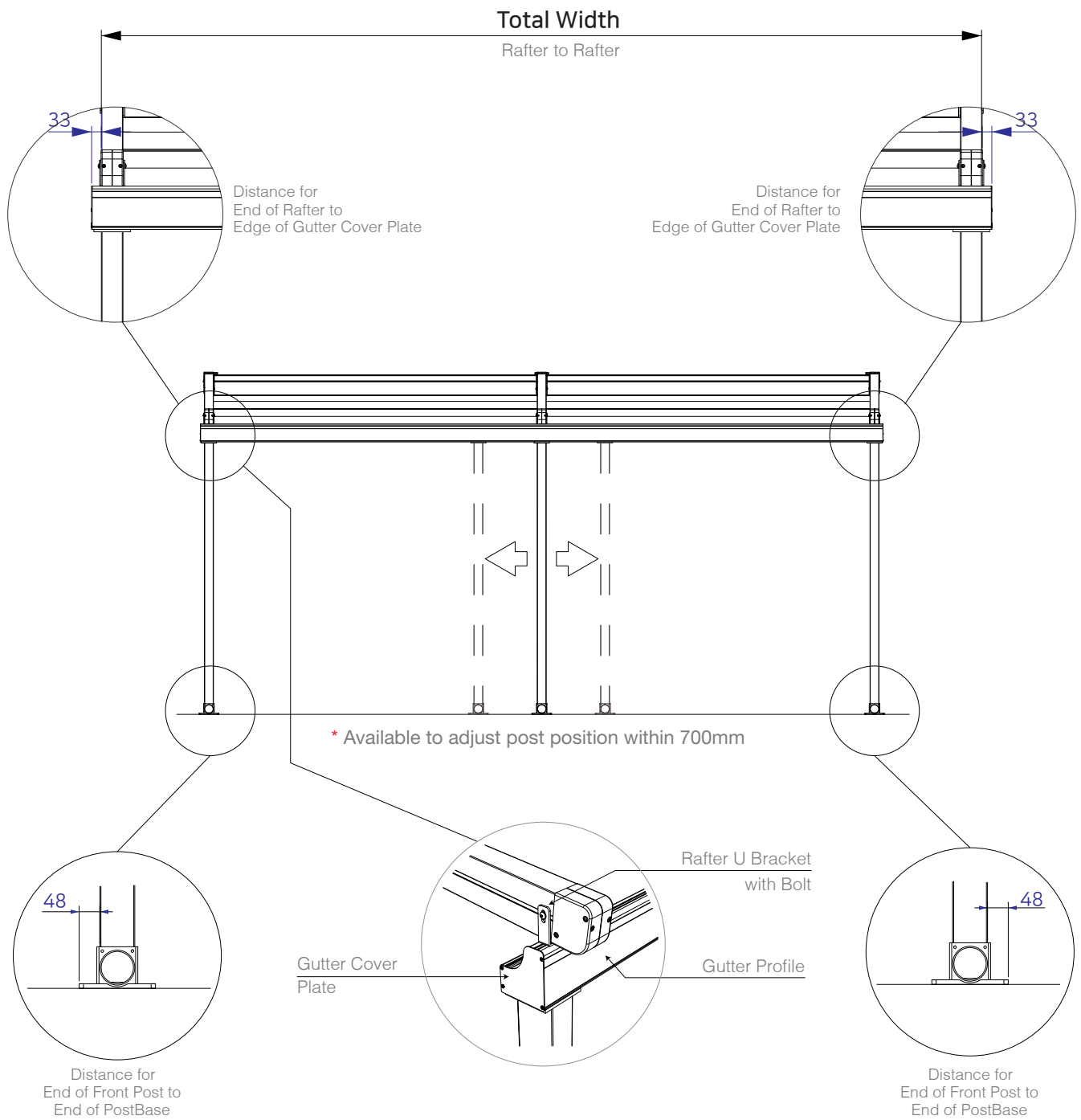

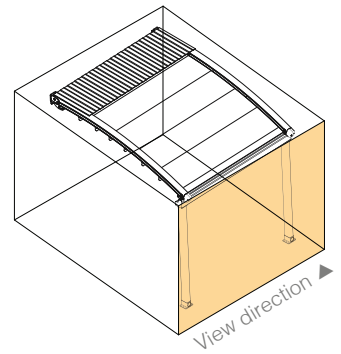

B. Projection & Height

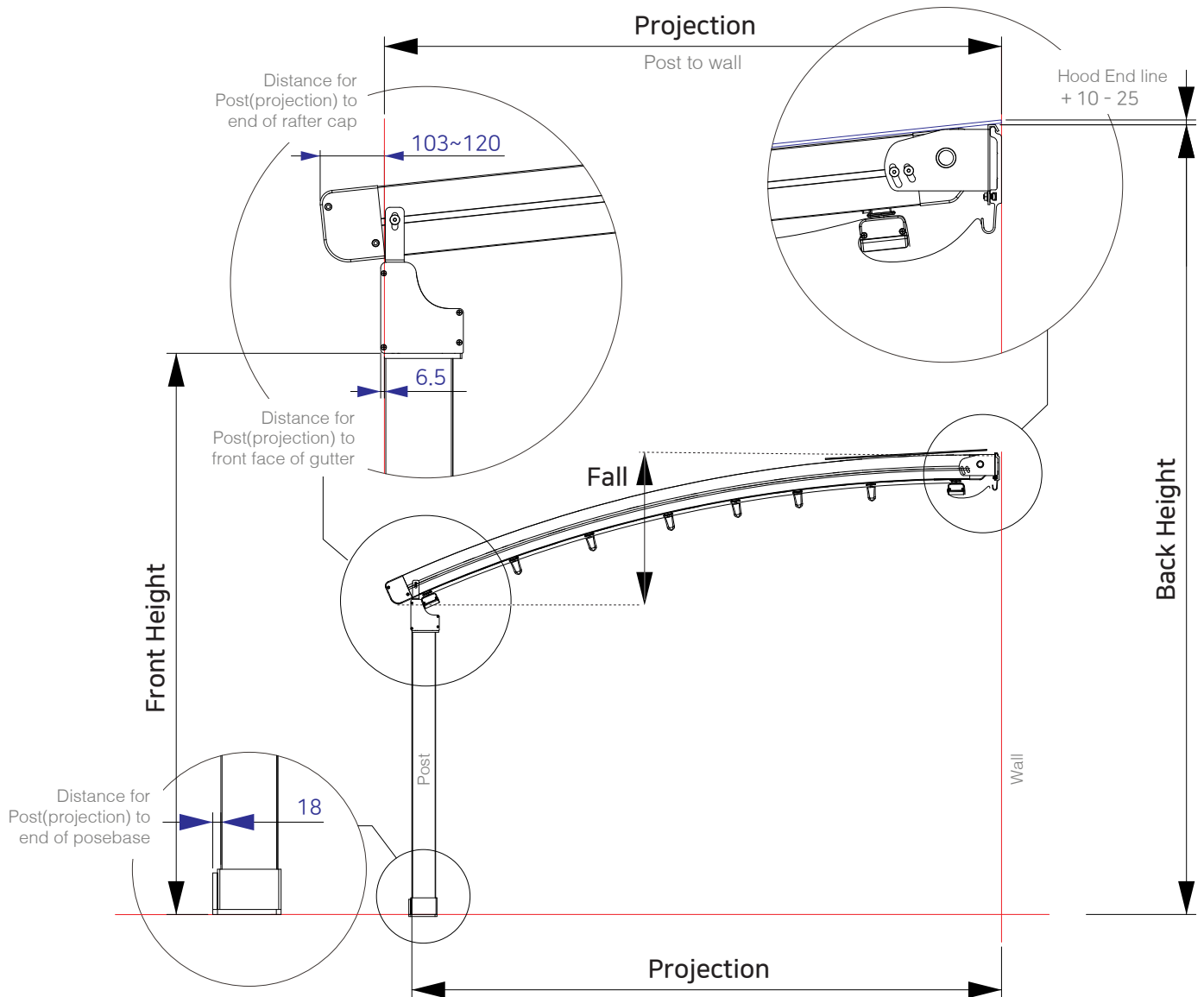

C. Angle

Unit : P - Meter Fall, Hood - mm

Projection	3.0	3.5	4.0	4.5	5.0	5.5	6.0	6.5	7.0	7.5	8.0	8.5	9.0	9.5	10.0
Fall (A)	849	1038	947	1106	1283	1478	1012	1120	1235	1358	1488	1626	1772	1926	2087
Radian	R10,058			R15,634			R35,193								

If lesser pitch than above table is required, please contact our staff for more details.



HARBOUR

Outdoor awnings
pergolas, curtain & blinds

HARBOUR

Outdoor awnings
pergolas, curtain & blinds



The HARBOUR retractable system is fully curved and is a free standing structure that highlights the area where it is installed.

The system is custom manufactured using high grade 6063 extruded aluminium profiles and is finished with thermoset powder coating which provides superior overall performance for exterior applications. All fixings are high grade stainless steel to ensure extended life.

Single Module

2m > 5m

Single module with
single motor & 2 rafters

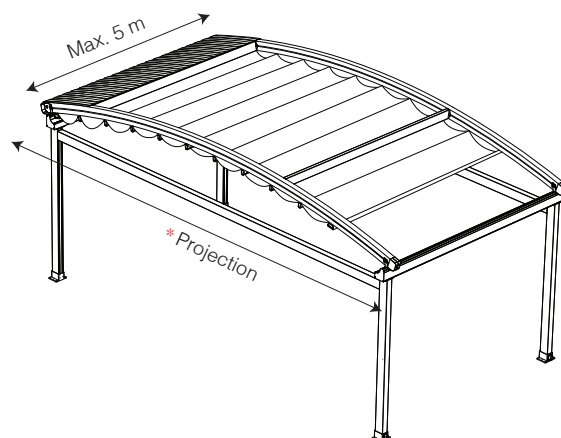

Projection

HARBOUR

- Max. 7 m

HARBOUR PLUS

- Max. 10 m

Double Module

5m > 9m

Double module with
single motor & 3 rafters

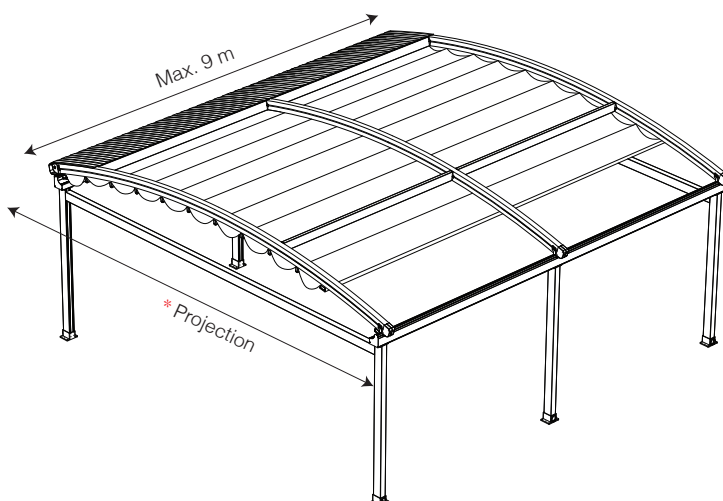

* Projection

HARBOUR

- Max. 7 m

HARBOUR PLUS

- Max. 10 m

Triple Module

9m > 13m

Triple module with
Single motor & 4 rafters

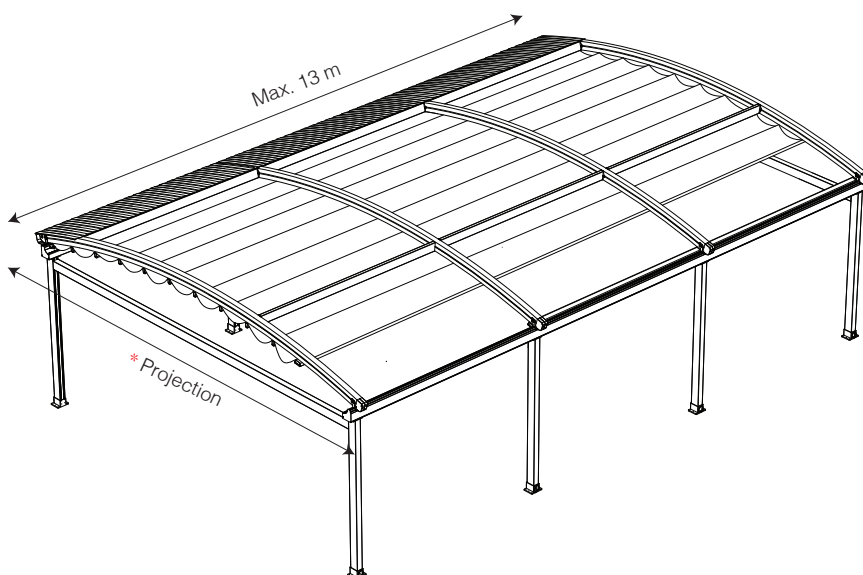

Projection

HARBOUR

- Max. 7 m

HARBOUR PLUS

- Max. 10 m



► PROFILE DETAILS

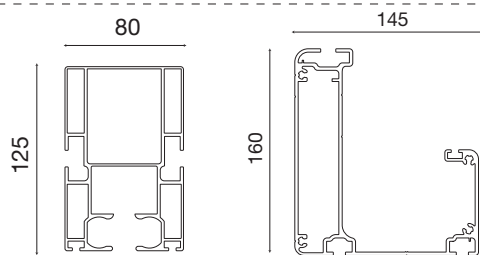

① Rafter

② Gutter

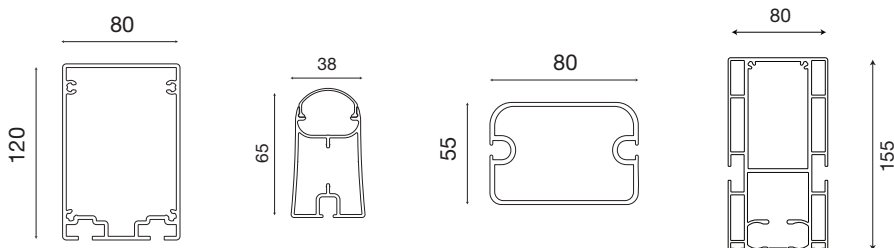

③ Post

④ Fabric Support
For Lighting

⑤ Puller Profile

⑥ Reinforcement
Rafter

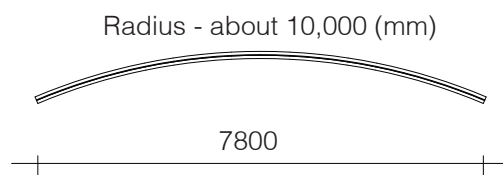
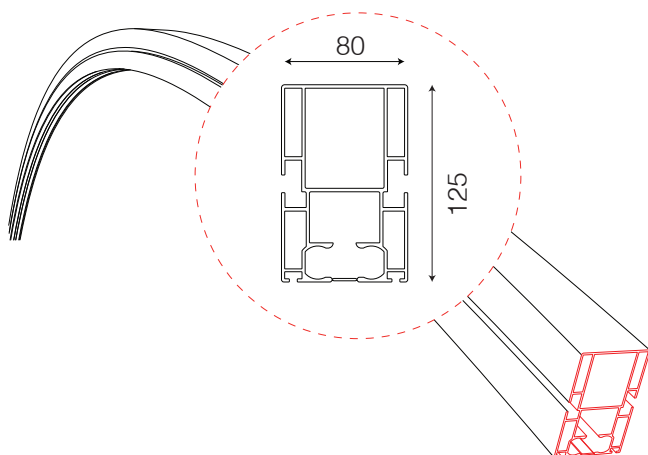

HARBOUR
Projection Max - 7.5 m

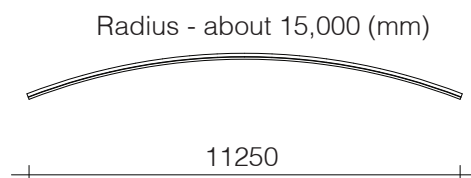
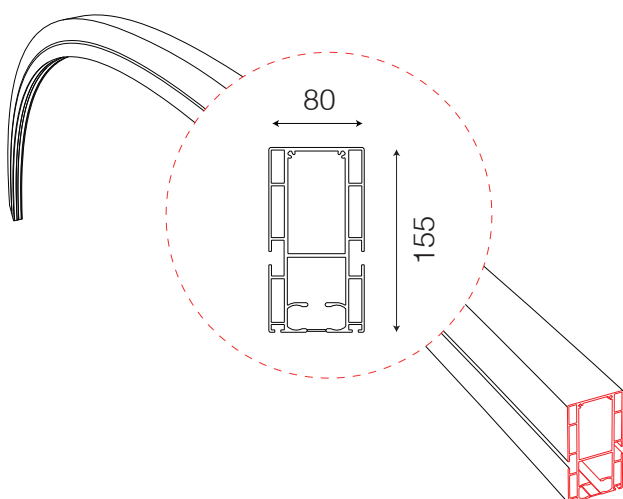

HARBOUR PLUS
Projection Max - 10 m

* Special Part - Please contact us

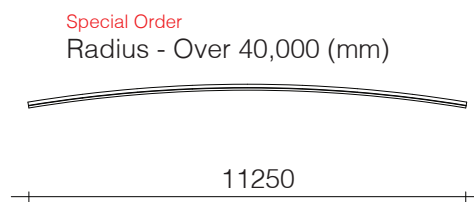
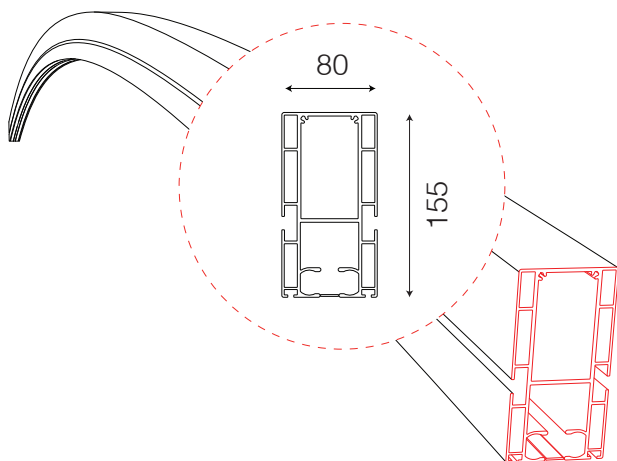

HARBOUR PLUS
Projection Max - 10 m

* Special Part - Please contact us

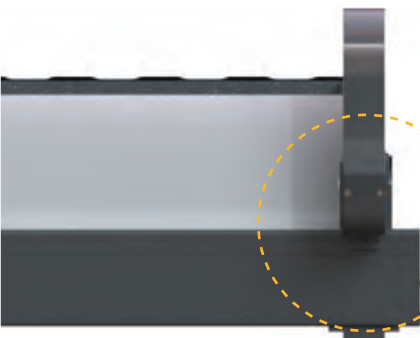

Front View ►

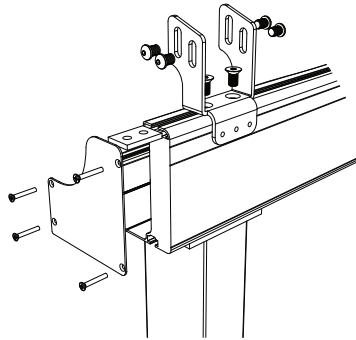

Front Side

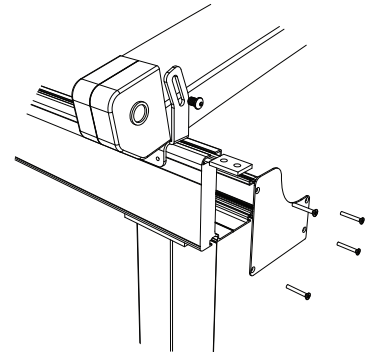

Motor Side



◄ Right View

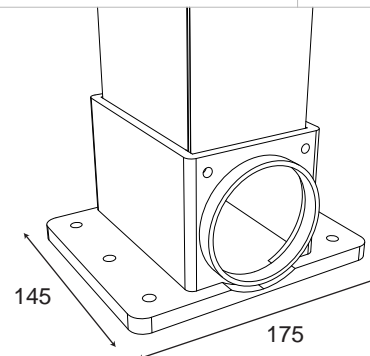
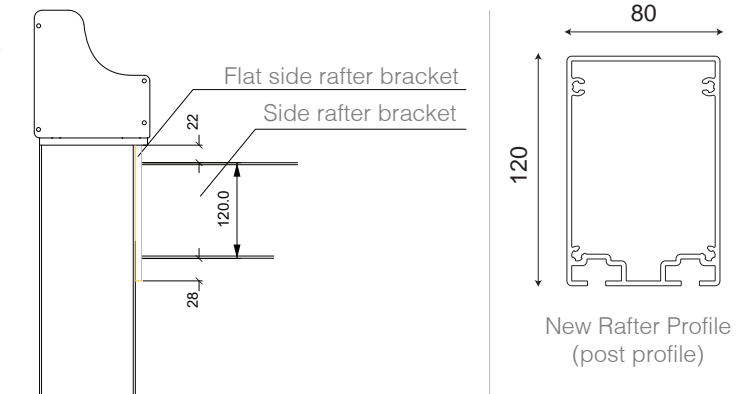

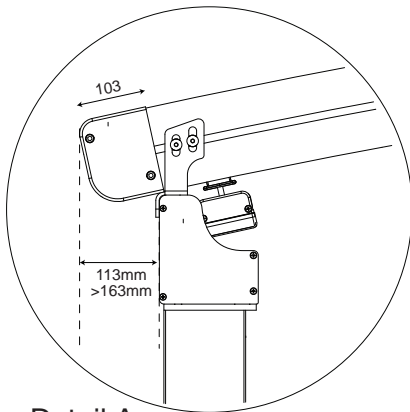
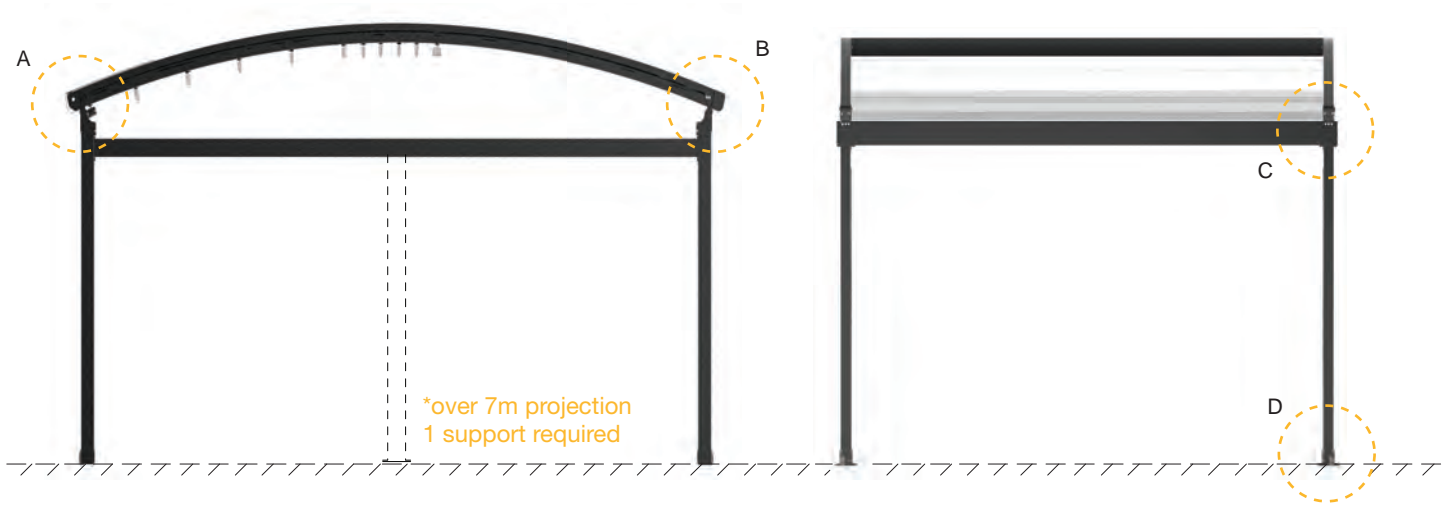

Detail A

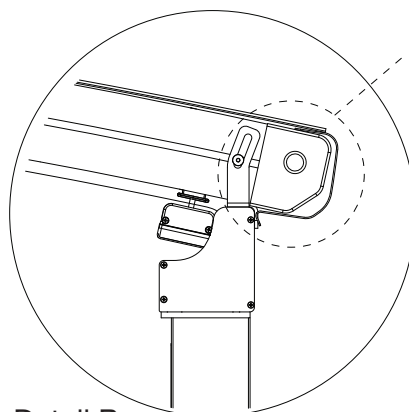

Detail B

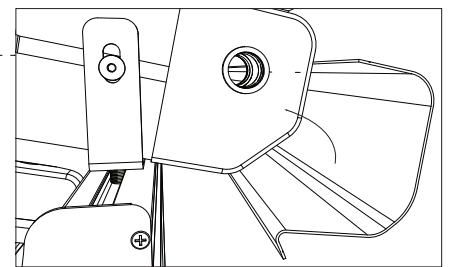

Back cover for Harbour system

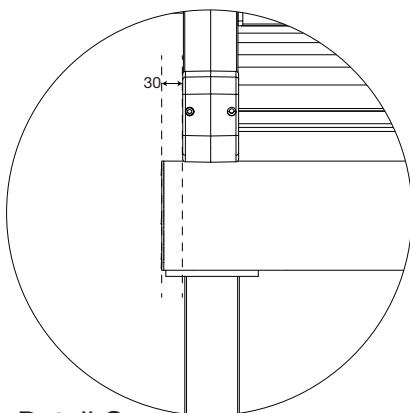

Detail C

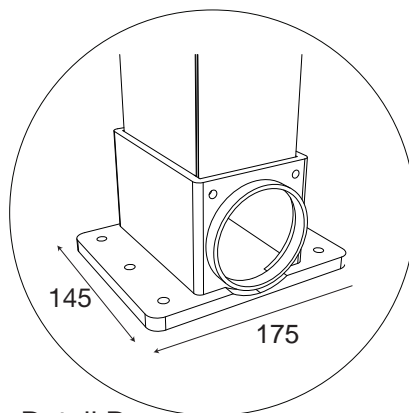

Detail D

HARBOUR

A. Width

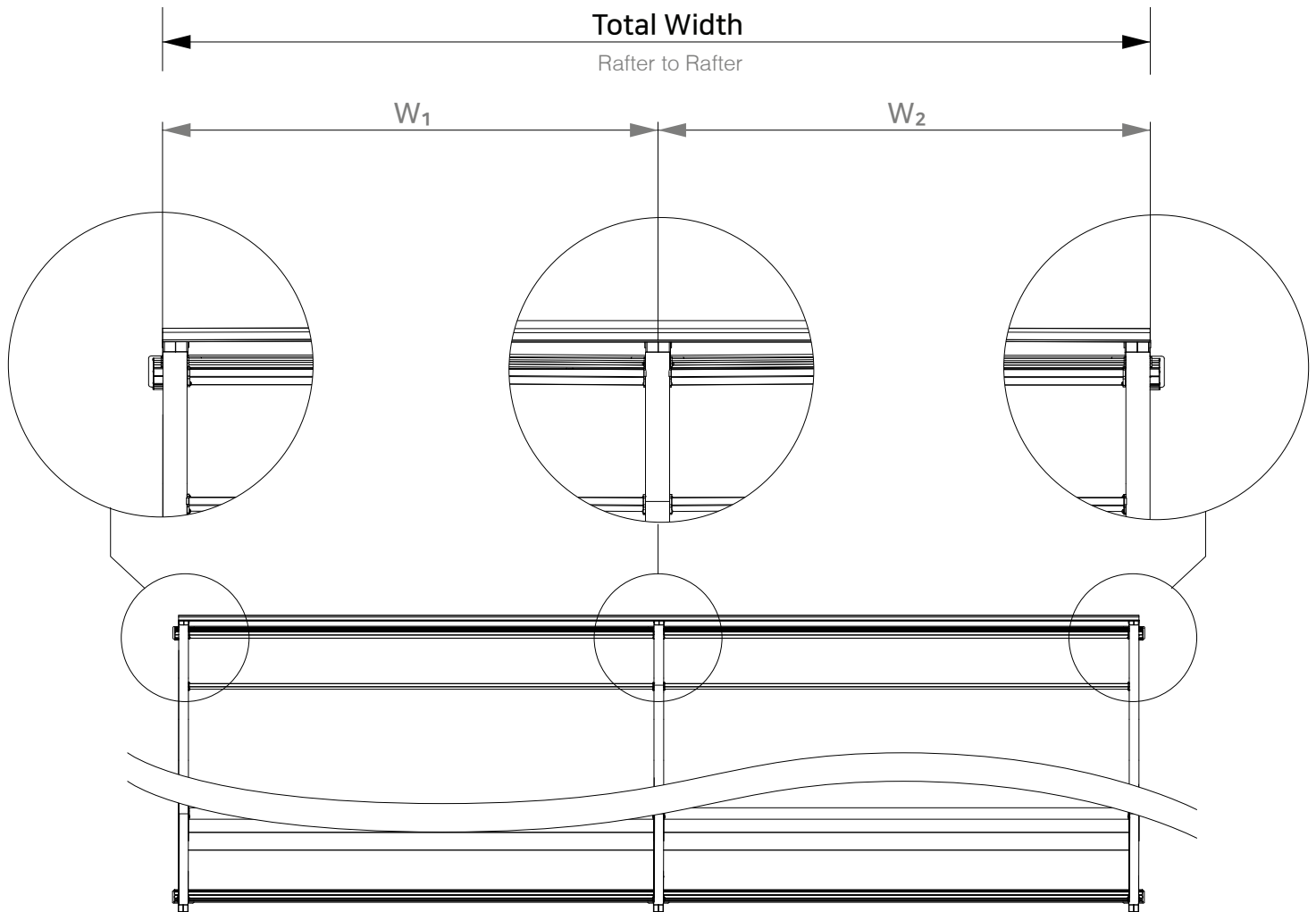
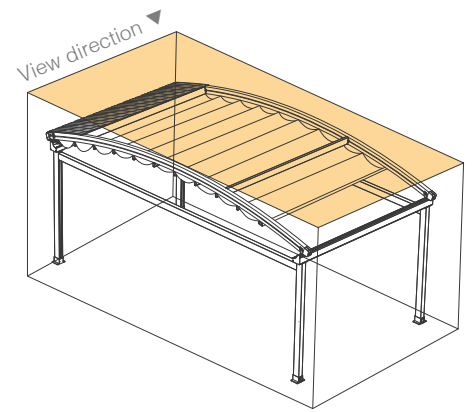

HARBOUR

B. Projection & Height

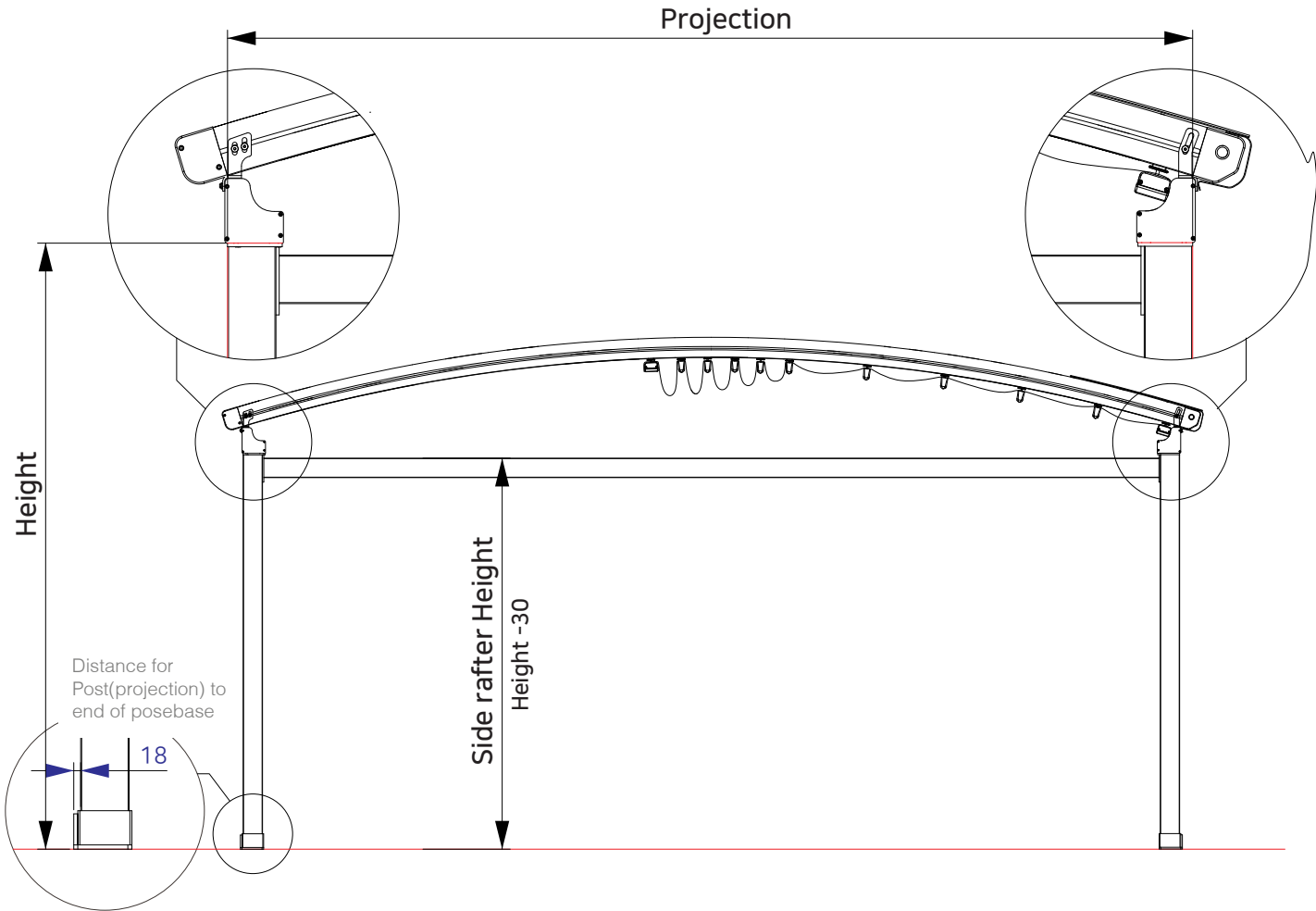
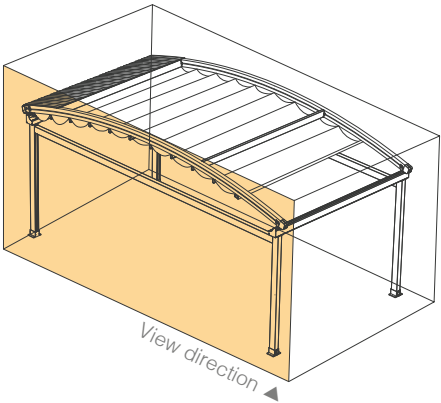

B. ANGLE

	HARBOUR										HARBOUR ⁺					
	Unit : P - Meter Fall, Hood - mm															
Projection	3.0	3.5	4.0	4.5	5.0	5.5	6.0	6.5	7.0	7.5	8.0	8.5	9.0	9.5	10.0	
Fall (A)	398	438	486	540	601	668	748	825	914	741	805	874	1024	947	1106	

If lesser pitch than above table is required, please contact our staff for more details.



T. 1300 552 516

H. www.oztech.com

E. info@oztech.com
